



扫一扫添加关注



Products Catalog
Fuse Series
熔断器导购手册



浙江驰风电气有限公司 电话 (Tel): 0086-577-61756778 传真 (Fax): 0086-577-61758755
ZHEJIANG CHIFENG ELECTRIC CO.,LTD.

A. 浙江省乐清市柳市陕西工业区凤湖路7-8号
A.No.7-8 Fenghu Road, Jiayi Industrial Zone, Liushi
Town, Yueqing City, Zhejiang Province, China
M.T: 13505872155
E-mail: admin@wzcfdq.com
http://www.wzcfdq.com www.wzcfdq.en.alibaba.com

由于拍摄及印刷的原因，产品图片与实物存在部分色差，敬请以产品实物为准！感谢您的理解！

浙江驰风电气有限公司
ZHEJIANG CHIFENG ELECTRIC CO.,LTD.



FUSE熔断器

Brief Introduction 公司简介

浙江驰风电气有限公司是一家专业生产熔断器的企业。公司位于中国低压电器之都-温州柳市。公司占地面积 3000 多平方米，注册资金 1000 万。公司集产品研发、制造、销售于一体，拥有雄厚的技术力量，先进的生产和检测设备。

本公司专注生产全系列低压交流与直流熔断器，公司主导产品有：NH、RT16(NT)、RT18 等线路过载或短路保护用低压熔断器，和 RS0、RS3、NGT 等半导体设备保护用低压熔断器；在新能源保护产品系列方面，公司研发出 gPV 光伏熔断器系列（CF-10PV、CFPV-30），广泛应用于光伏系统汇流箱；电动汽车直流熔断器产品(CFB及CFG)系列，广泛应用于电力驱动系统、电源系统和辅助系统的电路保护。产品符合国际电工委 IEC60269 标准和国家 GB13539 标准，并通过 ISO9001 质量管理体系，产品获得 CCC、CE、CB、TUV 等认证。产品畅销国内、欧洲、美洲、东南亚及中东等国家和地区。

走科技驰道，扬品质风帆。公司秉持诚实守信的经营宗旨，专业成就品牌的信念，不断创新和完善产品质量。多年来，**CHFE** 品牌产品赢得了广大国内外顾客的信赖。为了更好地开拓市场，竭诚欢迎国内外朋友惠顾，为我们更加辉煌的明天而携手共进。

Zhejiang Chifeng Electric Co.,Ltd. is a professional manufacture for fuses. The company is located in Liushi, Wenzhou -- the Capital of Low Voltage Electric in China, covering an area of over than 3000 square metres with registered capital of 1 million; and integrating r&d, manufacturing and sales, with strong technical force, advanced manufacturing and testing equipment.

Chifeng Company is focusing on full series of low voltage AC and DC fuses. The major products are NH, RT16(NT),RT18 etc. , used for overload or short circuit protection; and RS0, RS3, NGT etc. for semiconductor equipment protection. In the filed of the New Energy protection fuses, Chifeng company developed the gPV Fuse series (CF-10PV、CFPV-30) which is widely used in combiner box in solar systems; Electric Vehicle DC fuse (CFB, CFG) series widely used in the protection of electric-driven systems, power systems and auxiliary systems. Products meet the standard of IEC60269 and GB13539 and obtained ISO9001, CCC CE CB TUV certification, and sold well in domestic, Europe, America, Middle east and other countries and regions.

Committed to innovation, committed to quality. Chifeng company constantly innovates and improves, product quality based on honesty, integrity and profession. Products with **CHFE** brand win the trusts from both domestic and overseas customers. In order to expand a larger market, both domestic and oversea friends are sincerely welcomed to visit our company. We hope that we can join together to make a brilliant future.

走科技驰道 扬品质风帆
Committed to innovation committed to quality
[Http://www.wzcfdq.com](http://www.wzcfdq.com)



工于研发
获得多项自主专利

Work on development
Access to a number of Independent patents

三十年领航追求卓越品质

创名牌企业、造优质产品、送优良服务、铸一流品牌

30 years of navigation,
the pursuit of excellence quality

公司高度重视产品质量、安全、环保等工作，大部分产品通过3C、TUV、CE、CB等认证，并通过ISO9001:2015国际质量管理体系、建立起了规范的现代企业管理体系，在长期开展“现场质量评价”活动及“卓越绩效管理”的同时，始终牢记百分百合格品和零缺陷的质量意识，产品质量和性能得到了持续的优化和提升，确保了客户买得满意、用得放心！

FUSE

驰风熔断器

确保为行业用户提供一流的产品和服务
ENSURE THE PV INDUSTRY TO PROVIDE THE
BEST PRODUCTS AND SERVICES





目录 Contents

A	低压高分断能力熔断器 Low Voltage H.R.C Fuse	01/09
B	圆筒帽形熔断器 Cylindrical Fuse	10/16
C	螺旋式熔断器 Screw Base Type Fuse	17/22
D	螺栓连接式熔断器 Bolt Connected Fuse	23/27
E	方管螺栓连接式熔断体 Bolt Connected Square Pipe Type Fuse Links	28/30
F	圆筒螺栓连接式熔断体 Bolt Connected Round Cartridge Type Fuse Links	31/34
G	有填料方管螺栓交直流熔断体 Filled Square Bolted Type AC/DC Fuse Link	35/41
H	有填料汽车用交直流熔断体 Filled Auto AC/DC Fuse Link	42/43
I	熔断报警器 Fuse Alarms	44/45
J	载熔件(手柄) Fuse Carrier(Handle)	46
K	熔断器式隔离开关 Fuse-Type Disconnecter	47/50

熔断器设置在电路中主要功能是当电路发生故障时能安全可靠地切断，从而为各分立元器件或整个电路提供保护，以下为用户提供选择熔断器时需要考虑的有关条件。

The purpose of using fuses is to cut off the line safely and correctly to protect discrete components or the whole line in case of circuit errors. the following are the necessary conditions to be considered when selecting fuses.

正常工作条件和安装条件

Usual Service Conditions And Installation Conditions

- 周围空气湿度: -5℃~+40℃
 - 海拔高度: 不超过2000m
 - 大气条件: 湿度: 安装地点的空气相对湿度在最高温度为+40℃时不超过50%; 在较低的温度下可允许有较高相对湿度, 最湿月的月平均最低湿度不超过 +25℃, 该月的月平均最大相对湿度不超过 90%。由于温度变化发生在产品上的凝露情况必须采取措施。
 - 污染等级: 三级
 - 安装类别: III类
- Ambient temperature: -5℃ ~ +40℃
 - Height above sea level: not more than 2000m
 - Atmospheric condition: humidity: the installation site's relative air humidity does not exceed 50% while the maximum temperature is +40℃, And it can allow to have higher relative humidity under lower temperature. The average temperature does not exceed +25℃ while in the wettest month, and the maximum relative humidity does not exceed 90% in this month. We must take measures when there is condensation on the products which due to the changed temperature.
 - Class of pollution: Third class
 - Sort of installation: III

环境温度 Ambient Temperature

指直接环绕熔断器周围的空气温度，不应与室温相混淆。在许多实用场合，熔断器的温度相当高，这是因为熔断器是配置在不同结构的支持件/底座中以及整个熔断器又是封闭在配电/控制柜中。

Ambient temperature means the air temperature directly around the fuse, and should not be understood as the room temperature. In many application cases, the fuses are at rather high temperature as they are installed with supporting devices or bases in different structures and they are closed in the distributing or controlling boxes.

降容使用 Derating

在20℃环境湿度下，我们推荐熔断器的实际工作电流不应超过额定电流值。选用熔断器时应考虑到环境及工作条件，如封闭程度、空气流动、连接电缆尺寸(长度、截面)、瞬时峰值等方面的变化；熔断器的电流承载能力试验是在20℃环境温度下进行的，实际使用时受环境温度变化的影响，环境温度越高，熔断器的工作温度就越高，其寿命也就越短。相反，在较低的温度下运行将延长熔断器的寿命。下图表示环境温度对电流承载能力影响的典型曲线。

We recommend that the actual working current of a fuse should not exceed its rated current under the ambient temperature of 20℃. While selecting the fuses, environment and working conditions should be considered. Such as the variation of situation of closing, air flow, wire sizes(length and section)and instantaneous peak value etc. The current load capability of fuse links are tested under the ambient temperature of 20℃, However the actual load capability is affected by the ambient temperature. The higher the ambient temperature, the higher the working temperature and the shorter the service life of a fuse will be. On the other hand, the service life of a fuse can be longer when working under a lower ambient temperature.

The following is the typical curve showing the affection to the current load capability be the ambient temperature.

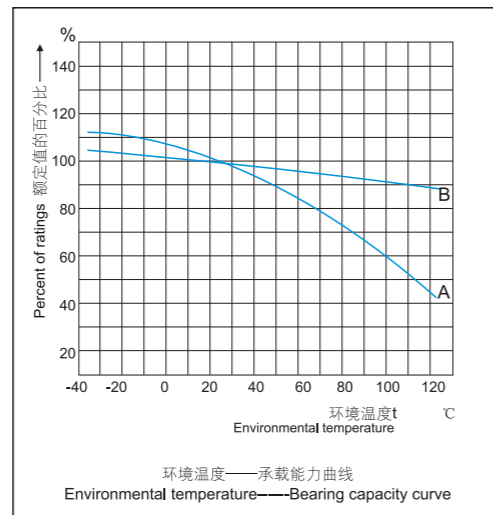

例如：在某一使用场合的环境温度为20℃，选用普通型(gG类)熔断器的额定电流In=63A，现在在上述熔断器用在70℃高温环境中工作，就必须额外减少工作电流，从上图环境温度——承载能力曲线 A 表明70℃时运行额定值的百分比为0.78，为确保熔断器不发生误动作，应重新选择熔断器的额定电流值：

$$I_n = \frac{63A}{0.78} = 80.77A$$

按熔断器标准电流等级选择In = 80A

其中：曲线A：线路保护用的普通型(gG)熔断器曲线；
曲线B：半导体器件保护用的快速型(aR)熔断器曲线。

E.g. when gG type fuse of 63A rating is used under ambient temperature of 20℃, reduction in working current is necessary when the ambient temperature is changed to 70℃. The ambient temperature-load capacity curve. A shows that the rating should be 78% at 70℃, and the new rating should be determined as:

$$I_n = \frac{63A}{0.78} = 80.77A$$

So fuse links of 80A rating should be selected for the new ambient temperature.

Note: A: (gG) type for line protection

B: (aR) type for semi-conductor protection

误动作 Malfunction

误动作常常是由于对所设计的电路分析不完全造成的。在“选择熔断器应考虑的因素”中，必须特别注意其中的 1)、3)、6) 三项，即正常工作电流、环境温度 and 过载增量。例如，造成常规运行时误动作的一种常见原因是没能充分考虑诸如电动机回路的起动电流、电容器回路的浪涌电流和谐波电流以及围绕在熔断器周围的空气温度等。

Malfunction is usually a result of incomplete analysis on the design of circuit, Special attention should be given to 1) normal rated current, 3) Ambient temperature, and 6) overload increment of factors to be considered for selection of fuses listed below. For example, frequent reasons for malfunction under normal working conditions are insufficient consideration to the start current of capacitor circuit and the ambient temperature around the fuse link.

额定分断能力 Rated Breaking Capacity

是熔断器在额定电压下能够可靠地熔断最大许可短路电流。短路时熔断器中会通过比其正常工作大得多的瞬时电流，安全运行要求熔断器保持完整的状态(无爆裂)切断电路。本公司熔断器额定分断能力至120KA。可靠的限流特性使电气线路中的设备免遭电力的破坏。

Rated breaking capacity is the maximum short-circuit current allowed for the fuse link to cutout reliably under rated voltage. The instantaneous current loaded to the fuse link is much larger than the normal working current when short-circuit occurs. The fuse link is supported to cutout the line in an undamaged condition i.e. without bursting. The rated breaking capacity of TIRH fuses is up to 120KA and the excellent current limiting characteristics reliably protect the equipment form damages by electric power.

熔断器限流特性波形示意图

Wave curve of current limiting characteristics of fuse link

图中Where: Is-预期电流 IP为100KA(有效值)的最大不对称电流峰值。

(短路电路中冲击系数取1.5)

Is-peak value of maximum asymmetric current at 100 KA perspective current IP.

(The impulse factor of a short circuit should be 1.5).

ID-实际分断时电流(载断电流)

Us-电弧电压

U- 电源电压

ts- 融化时间

tL- 燃弧时间

α -电压过零后的电弧始燃角

ID-The actual current at breaking

(limiting current)

Us-Arc voltage

U- Voltage

ts- Meltig time

tL- Arcing time

α -Burning corner of arc after zero voltage

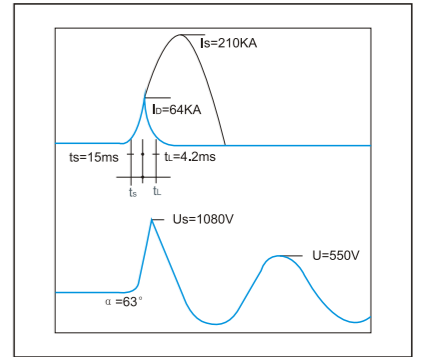

熔断器支持件(熔断器座) Fuse Supporter (Fuse Base)

在许多实用场合，熔断器安装在熔断器支持件/底座上，它们不能当作开关使用 - 不是用来接通或切断负荷的。

In many application cases, fuse links are installed on fuse supporters/fuse bases. They are not to be used as switches for connection and disconnection of the load.

选择熔断器应考虑的因素 Factors To Be Considered For Selection Of Fuses

- 正常工作电流；
 - 工作电压；
 - 环境温度；
 - 过载电流与熔断器必须熔断的时间；
 - 可能出现的故障电流；
 - 脉冲、冲击电流、浪涌电流、谐波电流、起动电流和电路过程瞬变值；
 - 结构尺寸、接线方式、目测指示(熔断与否)等。
- Normal working current
 - Working voltage
 - Ambient temperature
 - Overload current and cutout time
 - Possible malfunction current
 - Impulse current, surge current, starting current and transient value of the line
 - Size and dimensions, connection methods, indicators, etc.

电动机短路保护(aM)用熔断器

"aM"熔断器的门限

Gate limit of "aM" type fuse links:

Ip(In)	T熔断 < (s) T fusing < (s)	T弧前 > (s) T forearc > (s)
4	-	60
6.3	60	-
8	-	0.5
10	-	0.2
12.5	0.5	-
19	0.10	-

注: Ip-预期电流, In-熔断器额定电流

Note: Ip-Perspective current, In-Rated current of fuse link

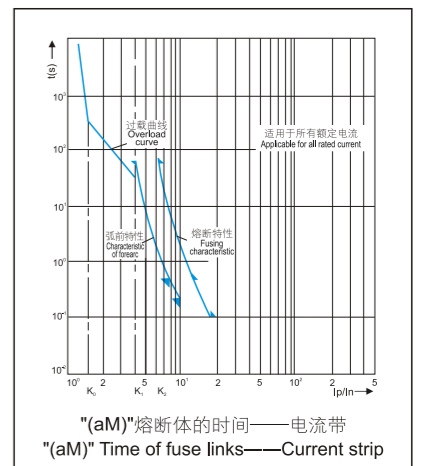

低压高分断能力熔断器
Low Voltage H.R.C Fuse

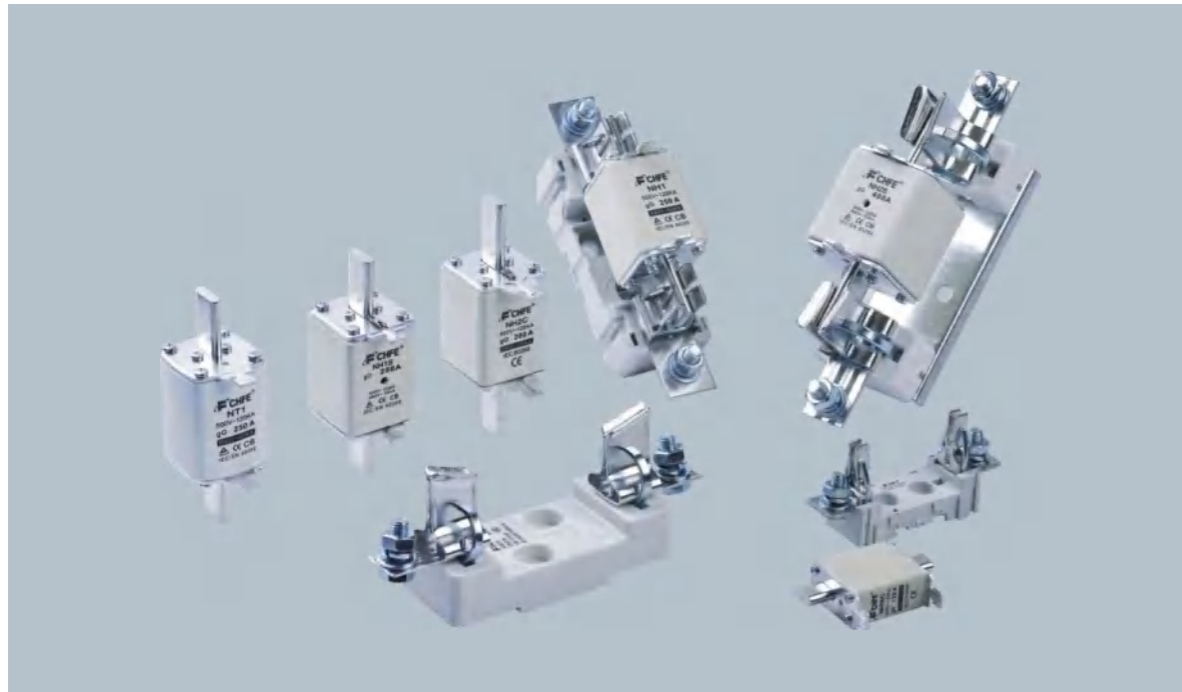

用途

本系列熔断体适用于交流50Hz, 额定电压至1140V, 额定电流至1250A, 主要用于电气装置中作线路过载和短路保护(gG/gL), 能可靠地分断最小熔化电流至120KA之间的任何电流。

亦可派生为半导体器件及其成套装置的短路保护(aR)以及电动机短路保护(aM)。

本系列熔断体, 符合国家标准 GB13539 和国际电工委标准 IEC60269。

结构特点

熔体采用高纯度优质金属丝材或带材, 灭弧介质是高纯度石英砂, 熔管为高强度陶瓷, 先进的制造工艺保证了本产品具有功耗小、特性稳定、其外形结构及安装尺寸同国内外同类先进产品接轨。

基本数据

熔断体型号、外形尺寸、额定电压、额定电流参考基本数据。

Applications

This series of fuse links is mainly used in AC 50Hz, rated voltage up to 1140V, rated current up to 1250A and for protecting electric equipment from overload and short-circuit. It can reliably break the min. fusion current to any current within 120KA.

It is also available for the protection of semiconductor parts and equipments against short-circuit (type aR) and protection of motors (type aM).

This series of fuse links conforms to GB13539 and IEC 60269 standards.

Design Features

It adopts the material with high quality. The arc-extinguishing medium is quartz sand and fuse tube is high strength ceramic. The advanced manufacturing craft work ensures the performance of small power waste, stable characteristic for the product. The outline structure and installation dimension joints the advanced similar products from domestic and abroad.

Basic Data

The model, outline dimension, rated voltage and rated current are shown in Figures.

> 基本数据 Basic Data



序号 No.	产品型号 Product model	国内外同类产品 Domestic and overseas similar products		额定 电压 Rated Voltage (V)	额定 电流 Rated current (A)	外形尺寸 Overall dimension (mm)				
		gG	aR			A	C	D	E	H
18001	NH00C	NH00C	RS30C	500/690	4-100	78.5	49.5	21	15	52.5
18002	NH00	NH00	RS31	500/690	10-160	78	50.5	30	15	60
18003	NH0	NH0		500/690	6-160	125	67	30	15	60

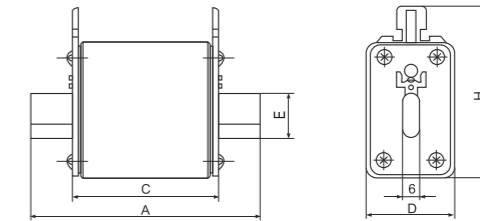

基本数据 Basic Data



序号 No.	产品型号 Product model	国内外同类产品 Domestic and overseas similar products		额定 电压 Rated Voltage (V)	额定 电流 Rated current (A)	外形尺寸 Overall dimension (mm)				
		gG	aR			A	C	D	E	H
18004	NH1	NH1	RS32	500/690	32-250	135	68	46	20	58.5
18005	NH2	NH2	RS33	500/690	80-400	150	68	58	25	68.5
18006	NH3	NH3	RS34	500/690	160-630	150	68	70	32	82

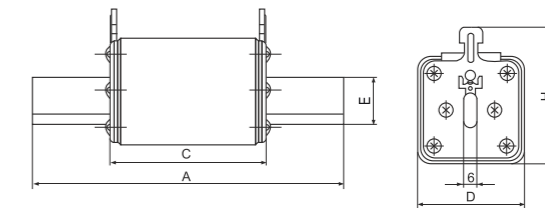

基本数据 Basic Data



序号 No.	产品型号 Product model	国内外同类产品 Domestic and overseas similar products		额定 电压 Rated Voltage (V)	额定 电流 Rated current (A)	外形尺寸 Overall dimension (mm)					
		gG	aR			A	B	C	D	H	J
18007	NH4	NH4	RS39	500/690	500-1250	200	150	90	97	113	16.5

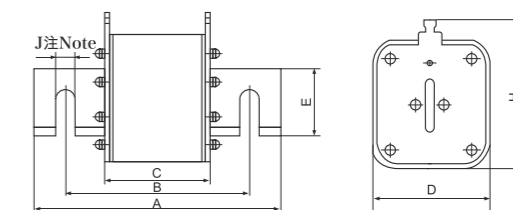

注: 允许将二横式接线孔, 改为一横一直或二直式结构
Note: It is allowable to change the double-transverse type wiring hole into one-transverse one-straight or double-straight type structure

> 基本数据 Basic Data



序号 No.	产品型号 Product model	国内外同类产品 Domestic and overseas similar products		额定 电压 Rated Voltage (V)	额定 电流 Rated current (A)	外形尺寸 Overall dimension (mm)							
		gG	aR			A	C	D	E	H			
18008	RO30A	NH00C		500/690	4-125	78	49	21	15	48			
18009	RT16-000	NT00C	NH00C	RS30C	500/690	4-125	78	49	21	52			
18010	RT16-00	NT00	NH00	RT20-00	3NA	RS31	500/690	4-160	78	49	29	15	56
18011	RT16-0	NT0		NH0	500/690	4-160	125	68	29	15	56		

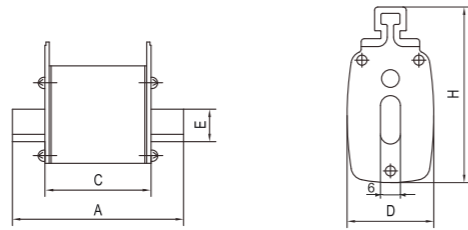

> 基本数据 Basic Data



序号 No.	产品型号 Product model	国内外同类产品 Domestic and overseas similar products		额定 电压 Rated Voltage (V)	额定 电流 Rated current (A)	外形尺寸 Overall dimension (mm)					
		gG	aR			A	C	D	E	H	
18012	RT16-1	NT1	NH1	RS32	500/690	32-250	135	68	48	20	60
18013	RT16-2	NT2	NH2	RS33	500/690	80-400	150	68	58	25	72
18014	RT16-3	NT3	NH3	RS34	500/690	160-630	150	68	68	32	84

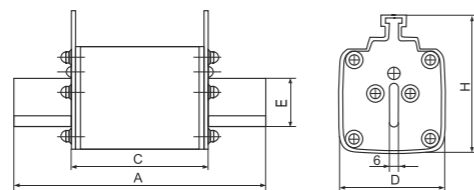

> 基本数据 Basic Data



序号 No.	产品型号 Product model	国内外同类产品 Domestic and overseas similar products		额定 电压 Rated Voltage (V)	额定 电流 Rated current (A)	外形尺寸 Overall dimension (mm)						
		gG	aR			A	B	C	D	H	J	
18015	RT16-4	NT4	RT17	RS39	500/690	500-1250	200	150	90	97	113	16.5

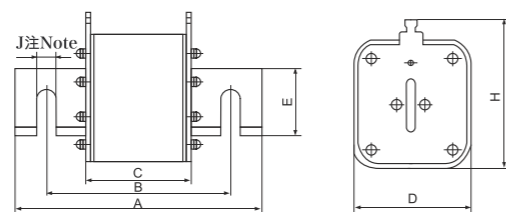

注：允许将二横式接线孔，改为一横一直或二直式结构
Note: It is allowable to change the double-transverse type wiring hole into one-straight one-straight or double-straight type structure

> 基本数据 Basic Data



序号 No.	产品型号 Product model	国内外同类产品 Domestic and overseas similar products	额定 电压 Rated Voltage (V)	额定 电流 Rated current (A)	外形尺寸 Overall dimension (mm)				
					A	C	D	E	H
18016	NH000S	NH000S	500/690	4-100	78.5	49.5	21	15	52.5
18017	NH00S	NH00S	500/690	10-160	78	50.5	30	15	60
18018	NH0S	NH0S	500/690	6-160	125	67	30	15	60

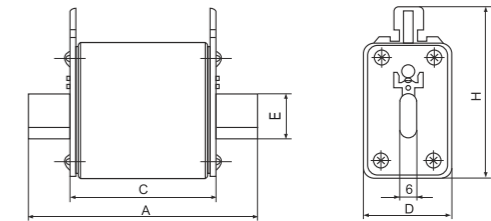

基本数据 Basic Data



序号 No.	产品型号 Product model	国内外同类产品 Domestic and overseas similar products	额定 电压 (V) Rated Voltage (V)	额定 电流 (A) Rated current (A)	外形尺寸 (mm) Overall dimension (mm)				
					A	C	D	E	H
18019	NH1S	NH1S	500/690	32-250	135	68	46	20	58
18020	NH2S	NH2S	500/690	80-400	150	68	58	25	68
18021	NH3S	NH3S	500/690	160-630	150	68	80	32	82

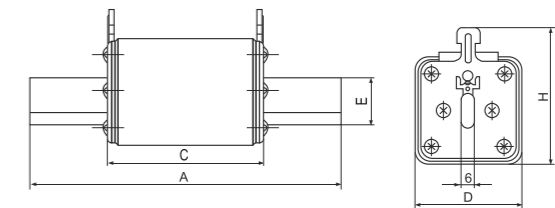

基本数据 Basic Data



序号 No.	产品型号 Product model	国内外同类产品 Domestic and overseas similar products	额定 电压 Rated Voltage (V)	额定 电流 Rated current (A)	外形尺寸 Overall dimension (mm)				
					A	C	E	D	H
18022	NH1C	NH1C(小容量) Small capacity	500/690	16-160	136	68	15	30	67
18023	NH2C	NH2C(小容量) Small capacity	500/690	35-250	150	67	20	46	67
18024	NH3C	NH3C(小容量) Small capacity	500/690	200-400	151	67	25	58.5	81.5

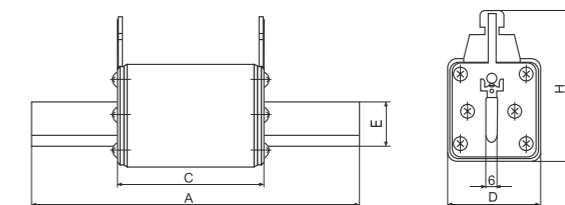

> 基本数据 Basic Data



序号 No.	产品型号 Product model	可配装熔断体型号、 尺码、规格 Model, size and specification of applicable fuse link	额定绝缘 电压 Rated insulation Voltage (V)	额定 电流 Rated current (A)	外形尺寸 (mm) Overall dimension (mm)			
					A	B	E	H
18025	NH00	NH00 NT00C (RT16-00 RT16-000 NH00)	690	160	119	100	23	57

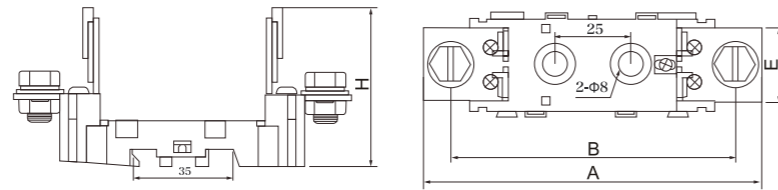

> 基本数据 Basic Data



序号 No.	产品型号 Product model	可配装熔断体型号、 尺码、规格 Model, size and specification of applicable fuse link	额定绝缘 电压 Rated insulation Voltage (V)	额定 电流 Rated current (A)	外形尺寸 (mm) Overall dimension (mm)			
					A	B	C	F
18030	RT16-00	NH000 NH00 RT16-000/00 NT00C/00	690	160	120	100	30	60

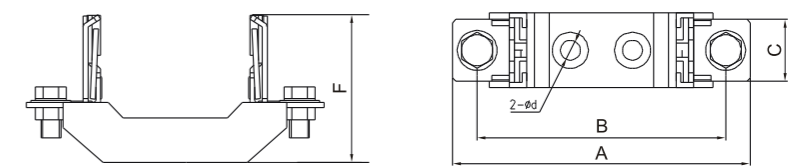

> 基本数据 Basic Data



序号 No.	产品型号 Product model	可配装熔断体型号、 尺码、规格 Model, size and specification of applicable fuse link	额定绝缘 电压 Rated insulation Voltage (V)	额定 电流 Rated current (A)	外形尺寸 (mm) Overall dimension (mm)			
					A	B	C	H
18026	NH00-3P	NH000 NH00 RT16-000/00 NT00C/00	690	160	146	101	54.5	68

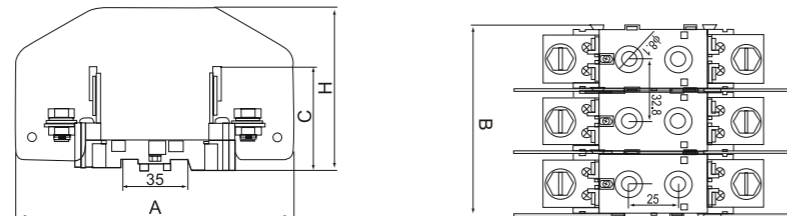

基本数据 Basic Data



序号 No.	产品型号 Product model	可配装熔断体型号、 尺码、规格 Model, size and specification of applicable fuse link	额定绝缘 电压 Rated insulation Voltage (V)	额定 电流 Rated current (A)	外形尺寸 (mm) Overall dimension (mm)				
					A	B	D1	D2	E
18031	NH00-3P	NH000 NH00 RT16-000/00 NT00C/00	690	160	123	103	103.5	33.5	25

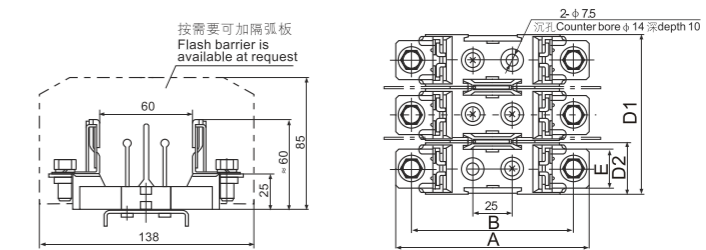

> 基本数据 Basic Data



序号 No.	产品型号 Product model	可配装熔断体型号、 尺码、规格 Model, size and specification of applicable fuse link	额定绝缘 电压 Rated insulation Voltage (V)	额定 电流 Rated current (A)	外形尺寸 (mm) Overall dimension (mm)				
					A	B	D	E	H
18027	NH1	RT16-1 NT1 NH1	690	250	208	176	58	32	82
18028	NH2	RT16-2 NT2 NH2	690	400	224	192	58	35	89
18029	NH3	RT16-3 NT3 NH3	690	630	239	207	58	40	106

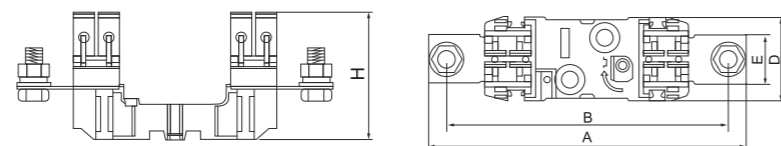

> 基本数据 Basic Data



序号 No.	产品型号 Product model	可配装熔断体型号、 尺码、规格 Model, size and specification of applicable fuse link	额定绝缘 电压 Rated insulation Voltage (V)	额定 电流 Rated current (A)	外形尺寸 (mm) Overall dimension (mm)			
					A	B	D	H
18032	RT16-0	NT0 NH0	690	160	170	150	30	72

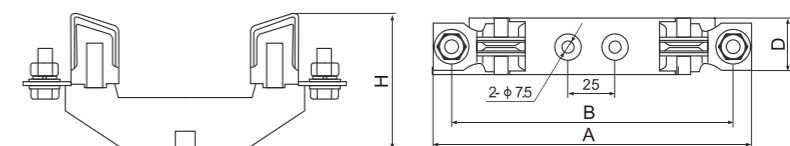

> 基本数据 Basic Data



序号 No.	产品型号 Product model	可配熔断体型号、 尺码、规格 Model, size and specification of applicable fuse link	额定绝缘 电压 Rated insulation Voltage (V)	额定 电流 Rated current (A)	外形尺寸 Overall dimension (mm)					
					A	B	D	E	H	Φd
18033	RT16-1	RT16-1 NT1 NH1	690	250	200	175	58	30	84	10.5
18034	RT16-2	RT16-2 NT2 NH2	690	400	225	200	60	30	100	10.5
18035	RT16-3	RT16-3 NT3 NH3	690	630	250	210	60	30	105	10.5

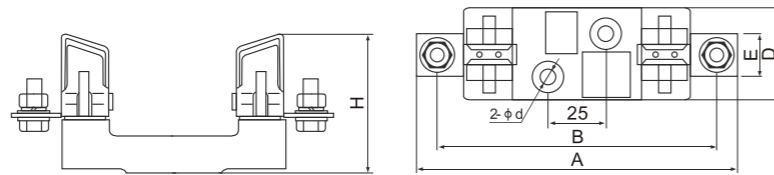

> 基本数据 Basic Data



序号 No.	产品型号 Product model	可配熔断体型号、 尺码、规格 Model, size and specification of applicable fuse link	额定绝缘 电压 Rated insulation Voltage (V)	额定 电流 Rated current (A)	外形尺寸 (mm) Overall dimension (mm)				
					A	B	D	E	H
18038	NT1	RT16-1 NT1 NH1	690	250	175	200	50	30	82
18039	NT2	RT16-2 NT2 NH2	690	400	200	230	64	30	104
18040	NT3	RT16-3 NT3 NH3	690	630	210	250	64	30	120

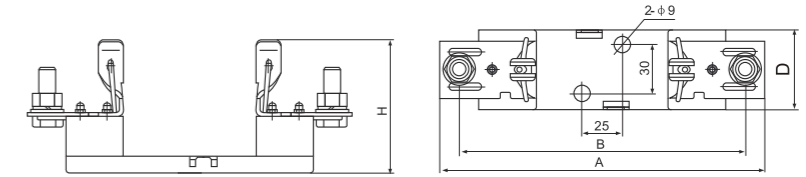

> 基本数据 Basic Data



序号 No.	产品型号 Product model	可配熔断体型号、 尺码、规格 Model, size and specification of applicable fuse link	额定绝缘 电压 Rated insulation Voltage (V)	额定 电流 Rated current (A)	外形尺寸 Overall dimension (mm)					
					A	B	C	D	E	H
18036	RT16-4	RT16-4 NT4 NH4	690	1250	305	260	150	95	45	148

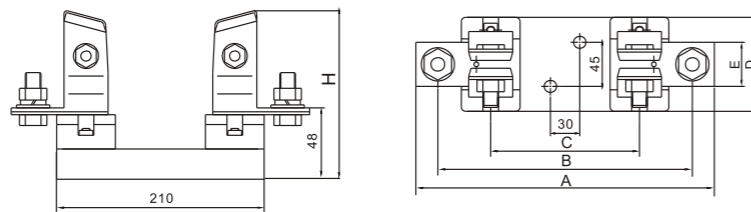

> 基本数据 Basic Data



序号 No.	产品型号 Product model	可配熔断体型号、 尺码、规格 Model, size and specification of applicable fuse link	额定绝缘 电压 Rated insulation Voltage (V)	额定 电流 Rated current (A)	外形尺寸 (mm) Overall dimension (mm)				
					A	B	D	E	H
18041	NH00	NH00C NH00	690	160	117	100	35	20	58

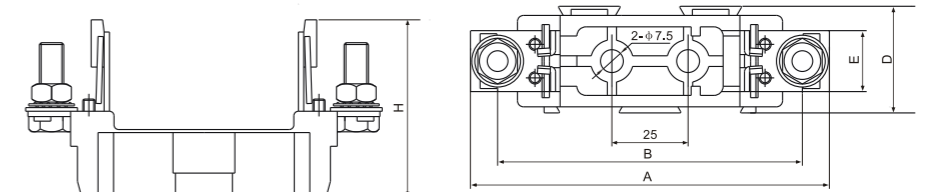

> 基本数据 Basic Data



序号 No.	产品型号 Product model	可配熔断体型号、 尺码、规格 Model, size and specification of applicable fuse link	额定绝缘 电压 Rated insulation Voltage (V)	额定 电流 Rated current (A)	外形尺寸 Overall dimension (mm)			
					A	B	D	H
18037	NT00	RT16-000/00 NT00C/00	690	160	120	100	32	61
18037-1	NT0	RT16-0 NT0	690	160	120	150	32	71

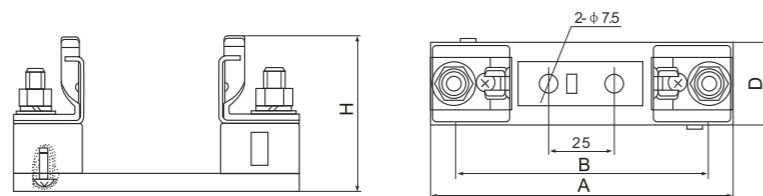

> 基本数据 Basic Data



序号 No.	产品型号 Product model	可配熔断体型号、 尺码、规格 Model, size and specification of applicable fuse link	额定绝缘 电压 Rated insulation Voltage (V)	额定 电流 Rated current (A)	外形尺寸 (mm) Overall dimension (mm)				
					A	B	D	E	H
18042	NH00	NH00C NH00	690	160	122	100	34	23	58

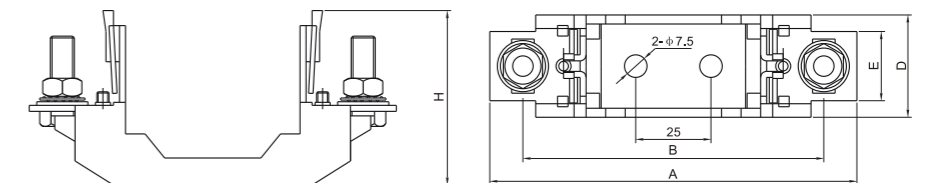

> 特性曲线 Characteristic curve

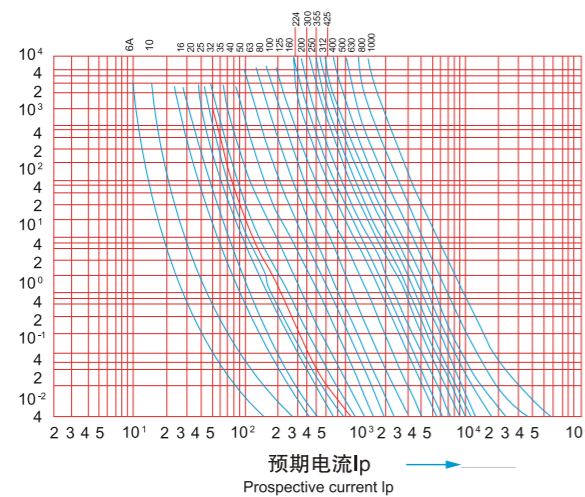
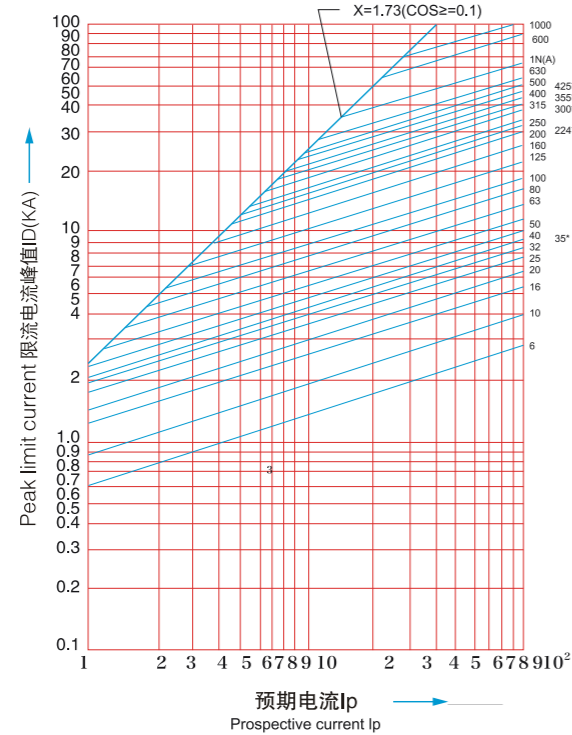

圆筒帽形熔断器
Cylindrical Fuse



用途

本系列熔断体适用于交流50Hz、额定电压至690V、额定电流至125A,主要作为电气线路过载和短路保护 (gG),还可派生为半导体器件及其成套装置的短路保护 (aR) 以及电动机短路保护 (aM)。本系列熔断体的额定分断能力至100KA。本系列熔断体符合国家标准GB13539和国际电工委标准IEC60269。

结构特点

由纯铜/银片 (或丝) 制成的变截面熔体封装于由高强度瓷或环氧玻璃布管制成的熔管内; 熔管中充满经化学处理过的高纯度石英砂作为灭弧介质。熔体两端采用电焊与接触端帽牢固连接。熔断体可带有撞击器, 当熔断体熔断时, 撞击器立即动作, 推动微动开关, 发出各种信号或自动切换电路。根据用户需要还可生产特殊熔断体。本系列熔断体呈插入式结构, 按尺码可安装于RT14、RT18、RT19以及其他相应尺码的熔断体支持件。

基本数据

熔断体型号、外形尺寸、额定电压、额定电流见基本数据图。

Applications

This series of fuse links is mainly used in AC 50Hz, rated voltage up to 690V, rated current up to 125A and for protecting electric equipment from overload and short-circuit. It can reliably break the min. fusion current to any current within 120KA. It is also available for the protection of semiconductor parts and equipments against short-circuit (type aR) and protection of motors (type aM). This series of fuse links conforms to GB13539 and IEC 60269 standards.

Design Features

Variable cross-section fuse element made from pure metal sealed in cartridge made from high-duty ceramic or epoxy glass. Fuse tube filled with chemically treated high-purity quartz sand as arc-extinguishing medium. Dot-welding of fuse element ends to the caps ensures reliable electric connection; Striker may be attached to the fuse link to provide immediate activation of micro-switch to give various signals or cut the circuit automatically. According to customer demands we can also produce special fuse body, this series of fuse-type plug-in structure, according to the size, it can be installed in the RT14, RT18, RT19 and other corresponding size fuse assembly.

Basic Data

The model, outline dimension, rated voltage and rated current are shown in Figures.

> 基本数据 Basic Data



序号 No.	产品型号 Product model	国内外同类产品 Domestic and oversea similar products	额定电压 Rated Voltage (V)	额定电流 Rated current (A)	外形尺寸 Overall dimension (mm)
					ΦD×L
18043	RO06	RO06	250/380	1~32	Φ12.7×29
18044	RO07	RO07	600	10~100	Φ30×57
18045	RO14	RT19-16 gF1	500	0.5~20	Φ8.5×31.5
18046	RO14A	RT19-16 gF1	250	0.5~20	Φ8.5×23
18047	RO15	RT14-20 gF2 RT18-32 RT19-25	380/500	0.5~32	Φ10.3×38
18048	RO15A		250	0.5~16	Φ10.3×25.8
18049	RO15B		250/500	0.5~25	Φ10.3×31.5
18050	RO15C		380/500	0.5~32	Φ10.3×35
18051	RO15T	ATQR KTK	380/600	0.5~32	Φ10.3×38
18052	RO16	RT14-32 gF3 RT18-63 RT19-40	380/660	2~50	Φ14.3×51
18053	RO17	RT14-63 gF4 RT18-125 RT19-100	380/660	10~125	Φ22.2×58
18054	RO19	FRS TRS FLSR	600	0.5~32	Φ20.5×127
18055	RO19H	FRS-R	600	0.5~63	Φ20.5×127
18056	RO54		250	0.5~16	Φ5×20
18057	RO55		250	0.5~16	Φ5×25
18058	RO57		250	0.5~16	Φ6.3×25
18059	RO58		250/500	0.5~16	Φ6.3×31.5

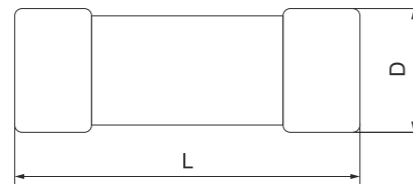

> 基本数据 Basic Data



序号 No.	熔断体型号 Model of fuse link				额定电压(V) Rated voltage (V)	额定电流(A) Rated current (A)	外形尺寸/尺码 Overall dimension/size ΦD × L
	本公司 The company		国内外同类产品 Domestic and oversea similar products				
	普通(gG) General	快速(aR) Quick speed	普通(gG) General	快速(aR) Quick speed			
18060	RO15T	RS15T	ATQR	KTK KTKR	380/600	0.5~32	Φ 10.3 × 38

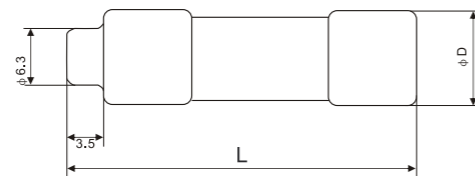

> 基本数据 Basic Data



序号 No.	熔断体型号 Model of fuse link				额定电压 Rated voltage (V)	额定电流 Rated current (A)	外形尺寸/尺码 Overall dimension/size ΦD × L
	本公司 The company		国内外同类产品 Domestic and oversea similar products				
	普通(gG) General	快速(aR) Quick speed	普通(gG) General	快速(aR) Quick speed			
18061	RO16H	RS16H	FRH-R	-	250	2~50	Φ 14.3×51
18062	RO17H	RS17H	-	-	380/500	10~125	Φ 22.2×58
18063	RO19H	RS19H	FRS-R	-	600	0.5~63	Φ 20.5×127
18064	RO19AH	RS19AH	FLNR	-	600	0.5~63	Φ 20.5×76
18065	RO19BH	RS19BH	-	-	600	0.5~63	Φ 20.5×114
18066	RO19CH	RS19CH	FRS-R	-	600	32~63	Φ 27×139
18067	RO19DH	RS19DH	-	-	600	32~63	Φ 27×147

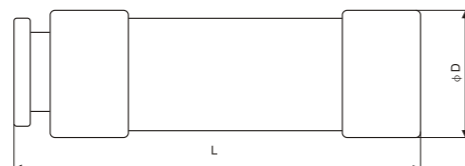

> 基本数据 Basic Data



序号 No.	产品型号 Product model	适配熔断体尺码 Applicable fuse link size	额定电压 Rated Voltage (V)	额定电流 Rated current (A)	外形尺寸 Overall dimension (mm)				
					A1	A2	B	H1	H2
18068	RT18-20(X)	8.5×31.5	500	20	80	82	18	60	78
18069	RT18-32(X)	10×38	500	32	79	81	18	61	80
18070	RT18-63(X)	14×51	500	63	103	105	27	80	110

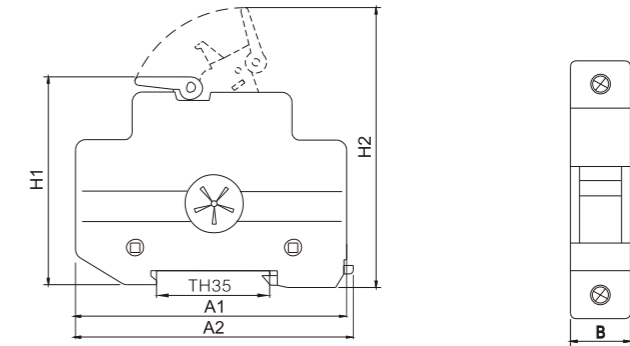

> 基本数据 Basic Data



序号 No.	产品型号 Model of product	适配熔断体尺码 Applicable fuse link size	额定电压 Rated Voltage (V)	额定电流 Rated current (A)	外形尺寸 Overall dimension (mm)				
					A1	A2	B	H1	H2
18071	RT18L-63	14×51	690	63	108	115	27	78	100
18071-1	RT18L-125	22×58	690	125	126	134	36	78	104

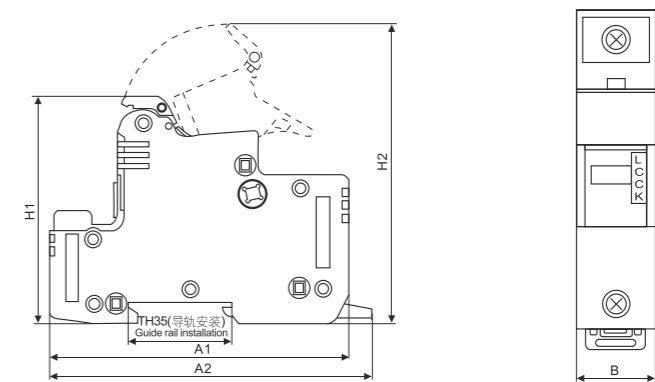

基本数据 Basic Data



序号 No.	产品型号 Product model	配套熔断体尺码 Applicable fuse link size	额定电压 Rated Voltage (V)	额定电流 Rated current (A)	外形尺寸 Overall dimension (mm)
18072	RT18N-10	8.5×23	500	10	详细数据见下图 Refer to for detailed data
18073	RT18N-16	10×25.8	500	16	
18074	RT18N-20	8.5×31.5	500	20	
18075	RT18N-25	10×31.5	500	25	
18076	RT18N-32	10×38	500	32	

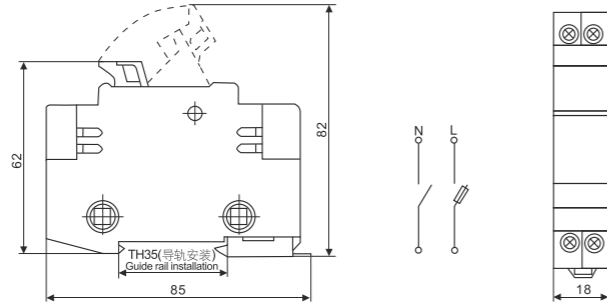

基本数据 Basic Data



序号 No.	产品型号 Product model	配套熔断体尺码 Applicable fuse link size	额定电压 Rated Voltage (V)	额定电流 Rated current (A)	外形尺寸 Overall dimension (mm)
18078	RT14-20	10×38	380/500	20	螺钉安装孔 $\phi 4.5$ 详细数据见下图 Screw mounting hole $\phi 4.5$, Refer to drawing 8.8 for detailed data
18079	RT14G-20	10×38	500	20	G32-15 导轨安装 详细数据见下图 G32-15 guide rail installation, Refer to for detailed data

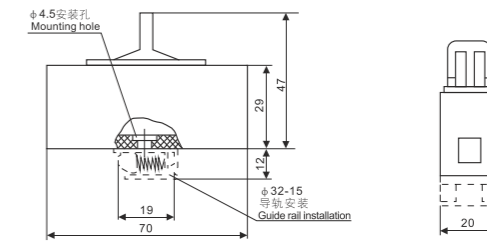

基本数据 Basic Data



序号 No.	产品型号 Product model	配套熔断体尺码 Applicable fuse link size	额定电压 Rated Voltage (V)	额定电流 Rated current (A)	外形尺寸 Overall dimension (mm)
18077	RT18-32N	10.3×38	690	32	详细数据见下图 Refer to for detailed data

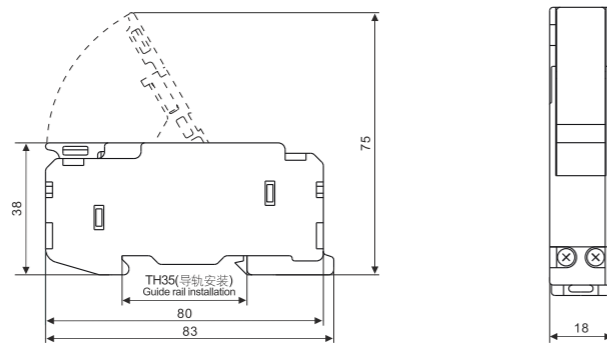

基本数据 Basic Data



序号 No.	产品型号 Product model	配套熔断体尺码 Applicable fuse link size	额定电压 Rated Voltage (V)	额定电流 Rated current (A)	外形尺寸 Overall dimension (mm)							
					A1	A2	A3	B1	B2	H1	H2	
18080	RT14-63A	22×58	500	100	101.5	100	48.5	16	35.5	52.5	134	

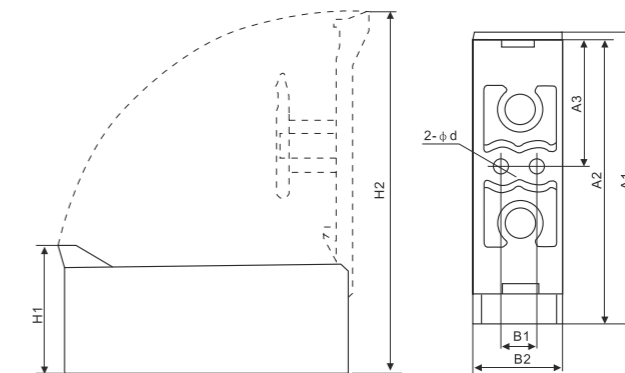

基本数据 Basic Data



序号 No.	产品型号 Product model	配套熔断体尺 码 Applicable fuse link size	额定 电压 Rated Voltage (V)	额定 电流 Rated current (A)	外形尺寸 Overall dimension (mm)							
					A1	A2	A3	B1	B2	H1	H2	Φd
18081	RT14-32B	14×51	500	32	98	95.5	42.5	12	30	45	123	5
18082	RT14-63B	22×58	500	100	101.5	100	48.5	16	35.5	52.5	134	6

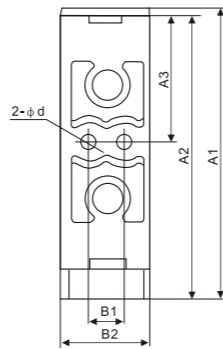
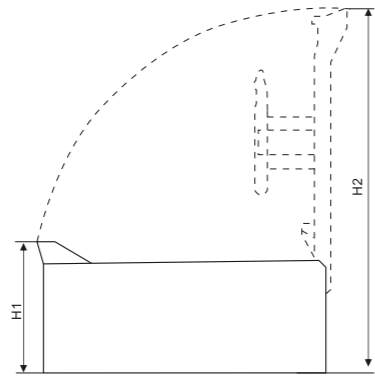

特性曲线 Characteristic curve

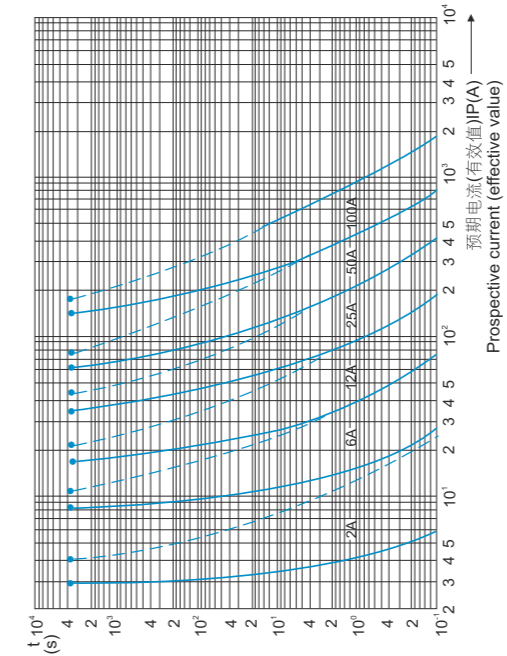

"gG" 熔断体的时间 — 电流带 Time-current band of "gG" fuse link

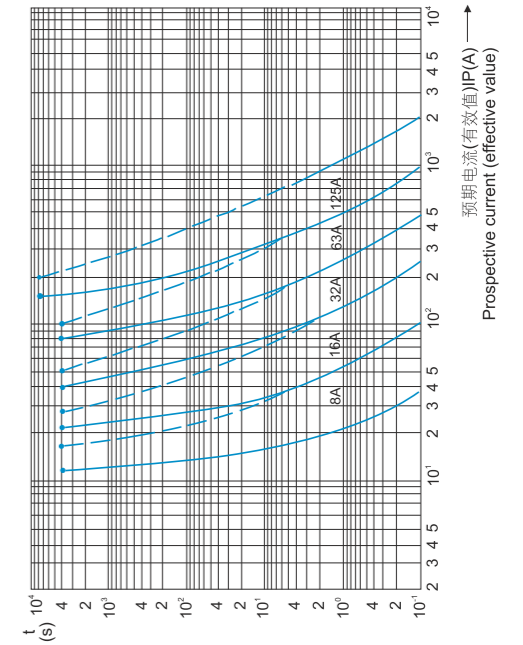

"gG" 熔断体的时间 — 电流带 Time-current band of "gG" fuse link

基本数据 Basic Data



序号 No.	产品型号 Product model	配套熔断体尺 码 Applicable fuse link size	额定 电压 Rated Voltage (V)	额定 电流 Rated current (A)	外形尺寸 Overall dimension (mm)
18083	RT14-25E	10.3×38	500	25	详细数据见下图 Refer to for detailed data
18084	RT14-20E	8.5×31.5	500	20	详细数据见下图 Refer to for detailed data

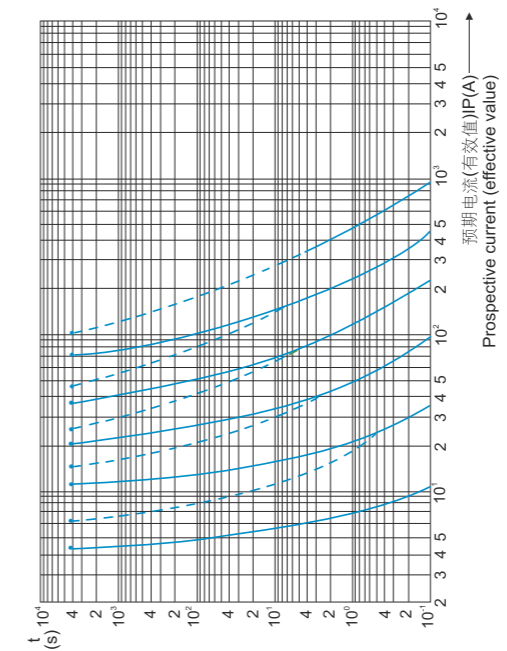
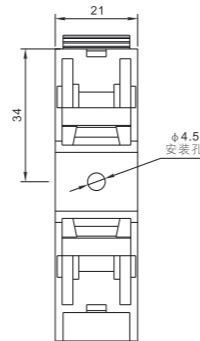
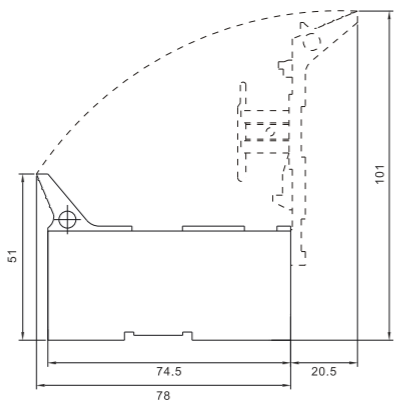

"gG" 熔断体的时间 — 电流带 Time-current band of "gG" fuse link

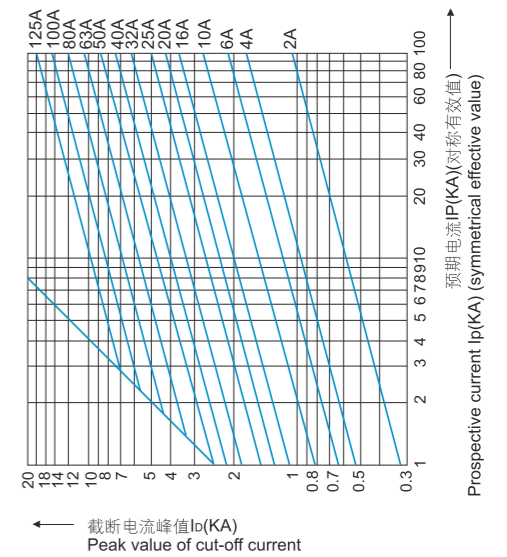

"gG" 熔断体的截断电流特性 Characteristic of cut-off current of "gG" fuse link

螺旋式熔断器
Screw Base Type Fuse



用途

本系列熔断体适用于交流50Hz、额定电压至690V、额定电流至125A,主要作为电气线路过载和短路保护 (gG),还可派生为半导体器件及其成套装置的短路保护 (aR) 以及电动机短路保护 (aM)。本系列熔断体的额定分断能力至50KA。本系列熔断体符合国家标准GB13539和国际电工委标准IEC60269。

结构特点

由纯铜/银片 (或丝) 制成的变截面熔体封装于由高强度瓷制成的熔管内; 熔管中充满经化学处理过的高纯度石英砂作为灭弧介质。熔断体帽端上熔断指示器, 当熔断体熔断时, 指示器立即弹出, 显示熔断体已熔断。根据用户需要还可生产特殊熔断体。

基本数据

熔断体型号、外形尺寸、额定电压、额定电流见基本数据图。

Applications

This series of fuse links is mainly used in AC 50Hz, rated voltage up to 690V, rated current up to 125A and for protecting electric equipment from overload and short-circuit. It can reliably break the min. fusion current to any current within 120KA.

It is also available for the protection of semiconductor parts and equipments against short-circuit (type aR) and protection of motors (type aM).

This series of fuse links conforms to GB13539 and IEC 60269 standards.

Design Features

Variable cross-section fuse element made from pure metal sealed in cartridge made from high-duty ceramic. Fuse tube filled with chemically treated high-purity quartz sand as arc-extinguishing medium. Indicator springs out when fuse cuts to give caution. According to the demand of customers we can also produce special fuse.

Basic Data

The model, outline dimension, rated voltage and rated current are shown in Figures.

> 基本数据 Basic Data



序号 No.	产品型号 Product model	国内外同类产品 Domestic and oversea similar products	额定 电压 Rated Voltage (V)	额定 电流 Rated current (A)	外形尺寸 Overall dimension (mm)			
					A	ΦD1	ΦD2	ΦD3
18085	RO21	5SB E27 RL6-25	500	2-6	50	22	13	6
				8-10	50	22	13	8
				13	50	22	15	8
				16	50	22	15	10
				20	50	22	15	12
18086	RO22	5SB E33 RL6-63	500	25	50	22	15	14
				30-40	50	27	20	16
				50	50	27	20	18
18087	RO24	E16 5SA	500	63	50	27	20	20
				2-6	50	12.5	11.3	6
				10	50	12.5	11.3	8
				16	50	12.5	11.3	10
				20-25	50	12.5	11.3	12

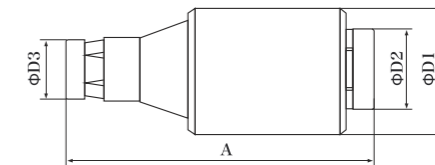

> 基本数据 Basic Data



序号 No.	产品型号 Product model	国内外同类产品 Domestic and oversea similar products	额定 电压 Rated Voltage (V)	额定 电流 Rated current (A)	外形尺寸 Overall dimension (mm)			
					A	ΦD1	ΦD2	ΦD3
18088	RO26	E14 RL8 5SE E18	400	2-6	36	7.3	10	5
				10	36	8.5	10	5
				16	36	9.7	10	5
			400	20	36	11	14	8.5
				25	36	12	14	8.5
				35	36	13.3	14	8.5
				50	36	14.5	14	8.5
			400	63	36	16	14	8.5
				80	43	22	21	17
				100	43	25	21	17

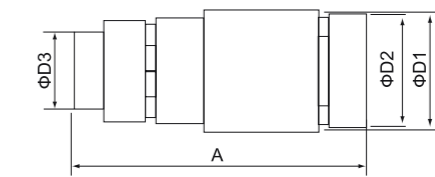

> 基本数据 Basic Data



序号 No.	产品型号 Product model	配套熔断体 Applicable fuse link	额定电压 Rated Voltage (V)	额定电流 Rated current (A)	外形尺寸 (mm) Overall dimension (mm)					
					A1	A2	B1	B2	B3	H
18089	FB24	DI E16 R024	500	25	25	35	30	33	56	68
18090	RL6-25	DIIR021E27	500	25	27	45	30	45	85	72
18091	RL6-63	DIIR022E33	500	63	38	53	33	54	85	80

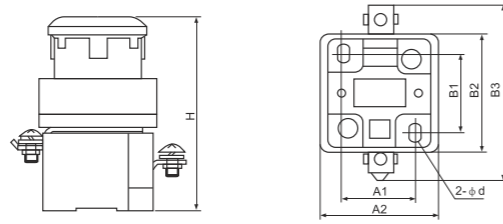

> 基本数据 Basic Data



序号 No.	产品型号 Product model	配套熔断体 Applicable fuse link	额定电压 Rated Voltage (V)	额定电流 Rated current (A)	外形尺寸 Overall dimension (mm)
					详细数据见下图 Refer to for detailed data
18094	FB26-100	R026 D03	500	100	

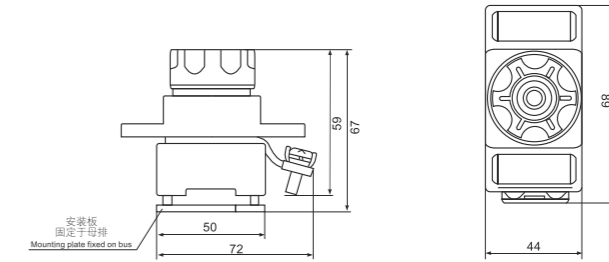

> 基本数据 Basic Data



序号 No.	产品型号 Product model	配套熔断体 Applicable fuse link	额定电压 (V) Rated Voltage (V)	额定电流 (A) Rated current (A)	外形尺寸 (mm) Overall dimension (mm)
18092	FB26A-63	E18 R206 D02	500	63	详细数据见下图 Refer to for detailed data

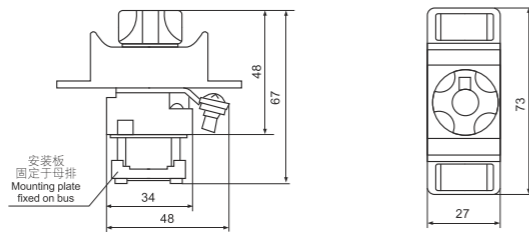

> 基本数据 Basic Data



序号 No.	产品型号 Product model	配套熔断体 Applicable fuse link	额定电压 Rated Voltage (V)	额定电流 Rated current (A)	外形尺寸 Overall dimension (mm)
18095	FB26H-100	R026 D03	500	100	详细数据见下图 Refer to for detailed data

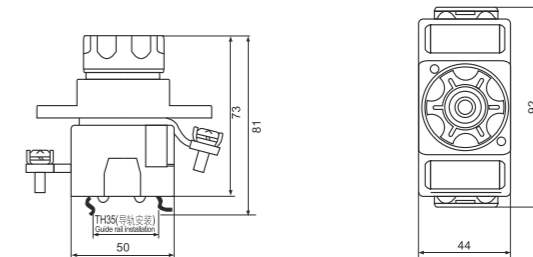

> 基本数据 Basic Data



序号 No.	产品型号 Product model	配套熔断体 Applicable fuse link	额定电压 Rated Voltage (V)	额定电流 Rated current (A)	外形尺寸 Overall dimension (mm)
18093	FB26-63	R026 D02	500	63	详细数据见下图 Refer to for detailed data

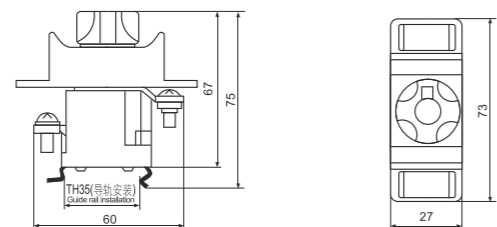

> 基本数据 Basic Data



序号 No.	产品型号 Product model	配套熔断体 Applicable fuse link	额定电压 Rated Voltage (V)	额定电流 Rated current (A)	外形尺寸 Overall dimension (mm)
18096	E27/3J	E27 DII	500	25	详细数据见下图 Refer to for detailed data
18097	E33/3J	E33 DIII	500	63	详细数据见下图 Refer to for detailed data

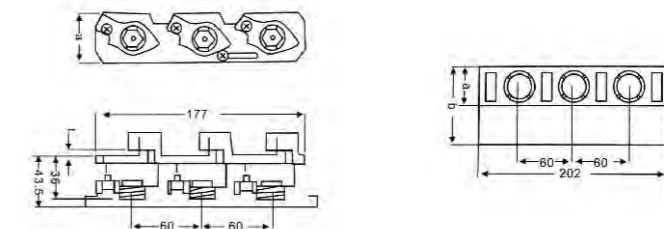

> 特性曲线 Characteristic curve

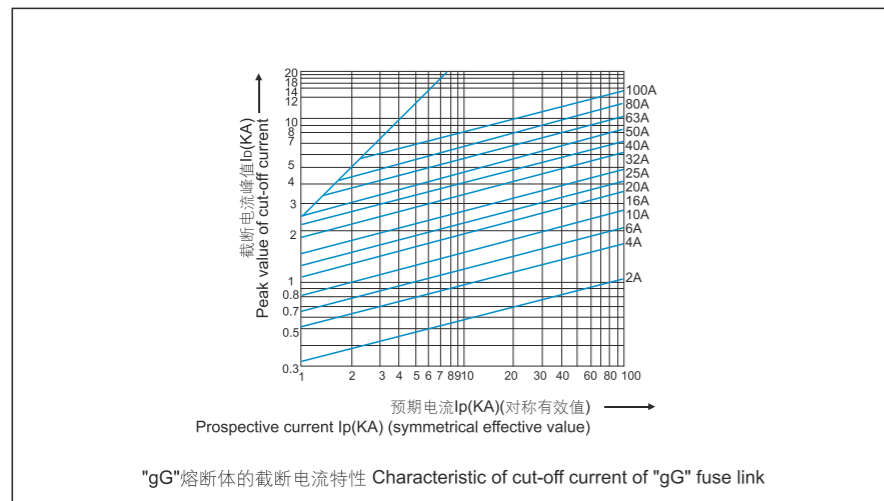
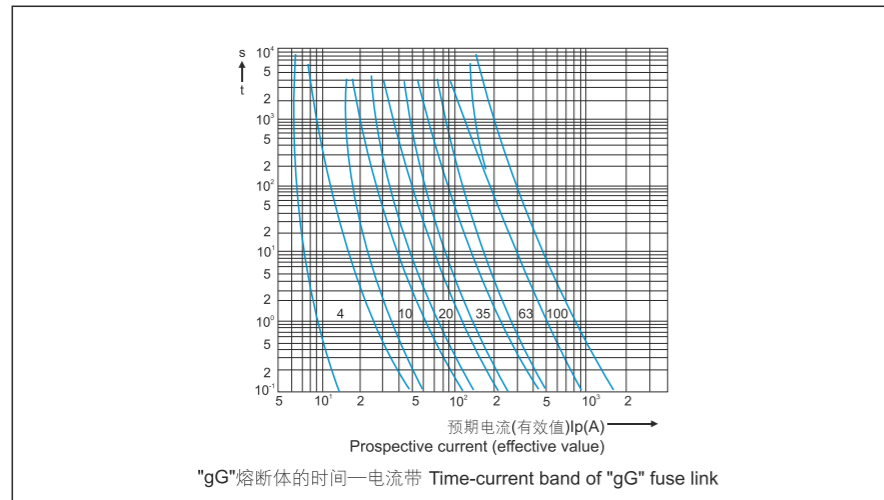
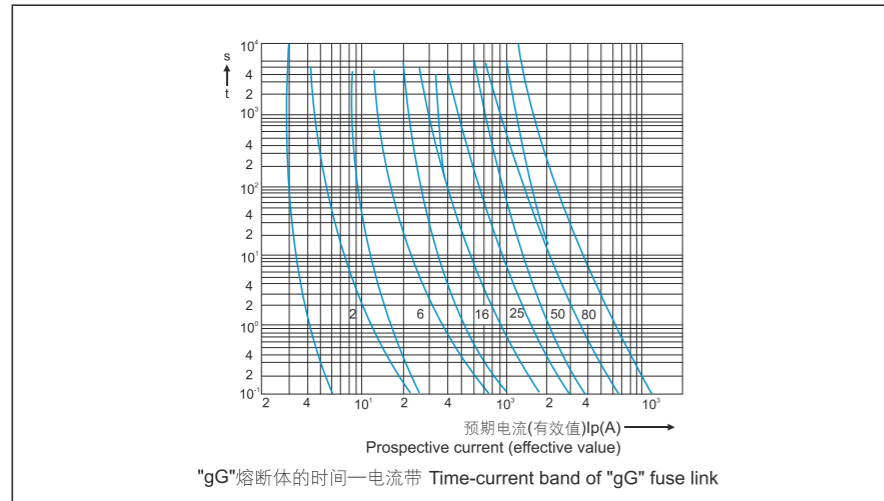

> 特性曲线 Characteristic curve

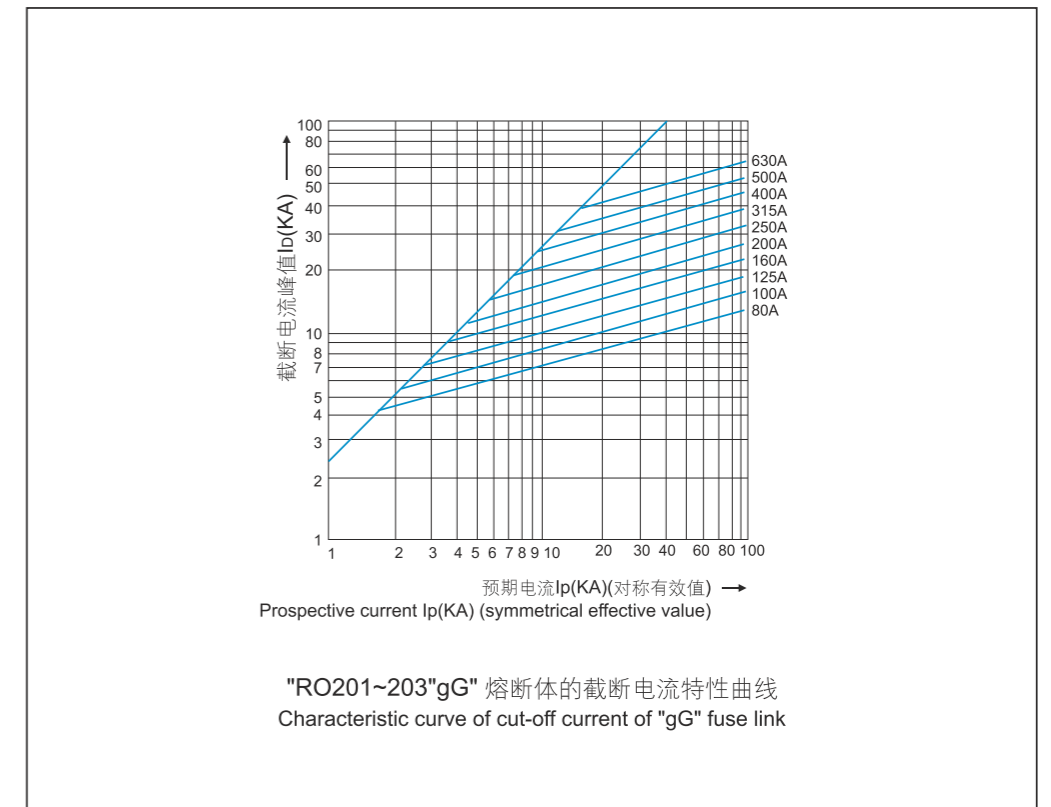
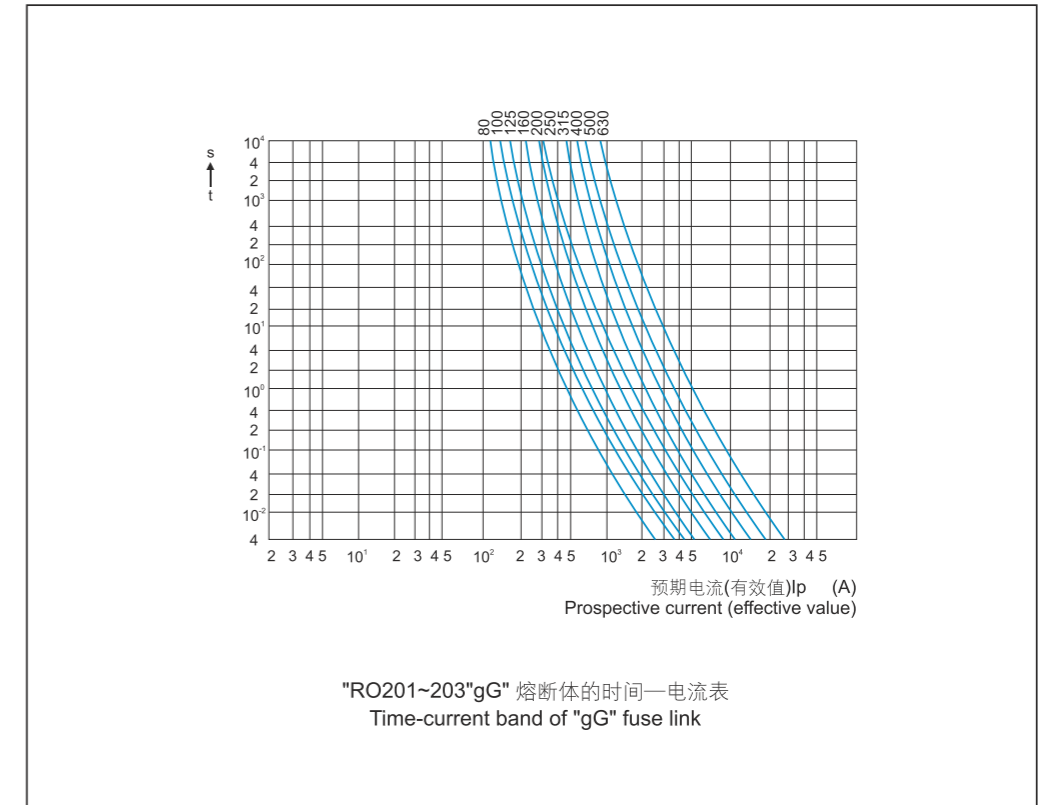

螺栓连接式熔断体
Bolt Connected Fuse Links

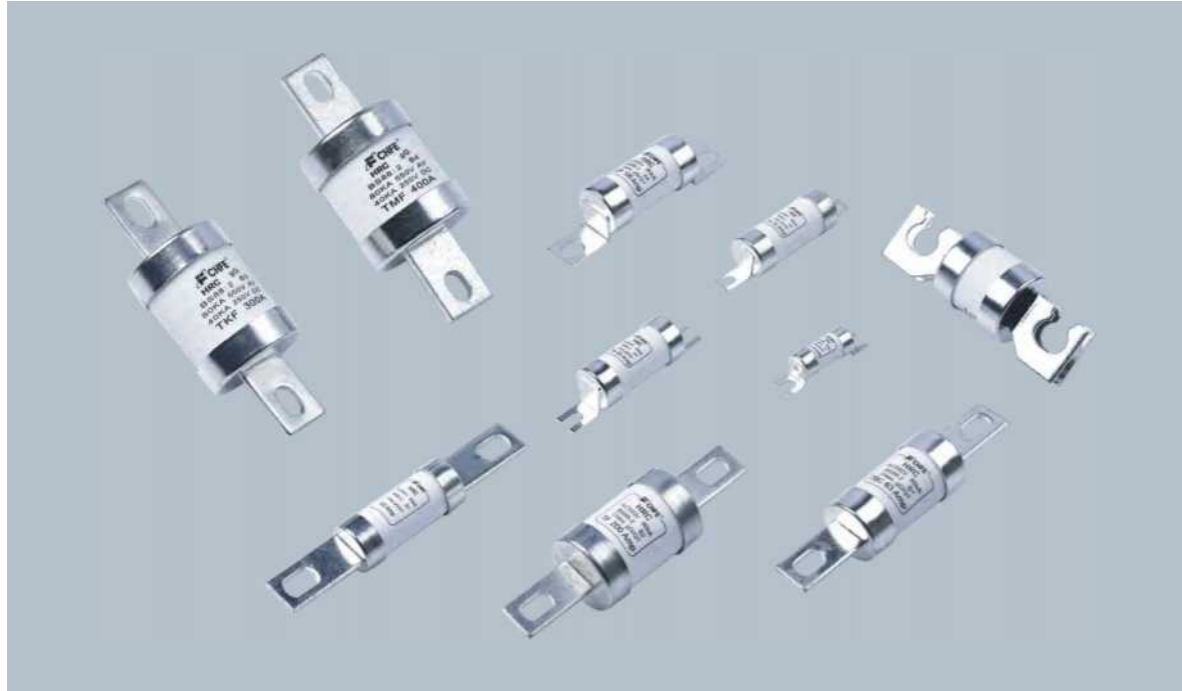

用途

本系列熔断体适用于交流 50Hz、额定电压至 1200V、额定电流至 630A 的电气装置中，有三种结构不同的熔体：一种作为电气线路的过载和短路保护 (gG)；另一种作为半导体器件及其成套装置的短路保护 (aR)；还可派生为电动机短路保护 (aM)。

本系列熔断体额定分断能力至 80KA。

本系列熔断体符合国家标准 GB13539 和国际电工委标准 IEC60269。

结构特点

由纯铜片/银片(或丝)制成的变截面熔体封装于由高强度瓷或环氧玻璃布管制成的熔管内；熔管中充满经化学处理过的高纯度石英砂作为灭弧介质。熔体两端采用点焊与接触端帽牢固电连接。熔断体可带有撞击器，当熔断体熔断时，撞击器立即动作，推动微动开关，发出各种信号以及自动切换电路。

基本数据

熔断体型号、外形尺寸、额定电压、额定电流参考基本数据。

Applications

This series of fuse links is mainly used in AC 50Hz, rated voltage up to 1200V, rated current up to 630A and for protecting electric equipment from overload and short circuit. It can reliably break the min. fusion current to any current with in 120KA. It is also available for the protection of semiconductor parts and equipments against short-circuit (type aR) and protection of motors (type aM). This series of fuse links conforms to GB13539 and IEC 60269 standards.

Design Features

Variable cross-section fuse element made from pure copper or silver sealed in cartridge made from high-duty ceramic or epoxy glass. Fuse tube filled with chemically treated high-purity quartz sand as arc-extinguishing medium. Dot-welding of fuse element ends to the terminals ensures reliable electric connection and forms insert knife type contacts. Striker may be attached to the fuse link to provide immediate activation of microswitch to give various signals or cut the circuit automatically.

Basic Data

The model, outline dimension, rated voltage and rated current are shown in Figures.

> 基本数据 Basic Data



序号 No.	产品型号 Product model	国内外同类产品 Domestic and oversea similar products	额定 电压 Rated Voltage(V)	额定 电流 Rated current(A)	外形尺寸 Overall dimension (mm)				
					A	C	ΦD	E	F
18098	RGO	NS	415	1~32	59	32	13.5	11	0.8

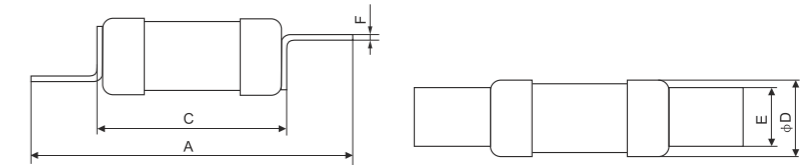

> 基本数据 Basic Data



序号 No.	产品型号 Product model	国内外同类产品 Domestic and oversea similar products	额定 电压 Rated Voltage(V)	额定 电流 Rated current(A)	外形尺寸 Overall dimension (mm)							
					A	B	C	ΦD	E	F	H	Φd
18099	RGOK	NIT	415	1~32	55	45	34	13.5	11	0.8	14.5	5
18100	RG2	TIS	500	40~100	88	75	56	25.5	13	1.2	27	6.5

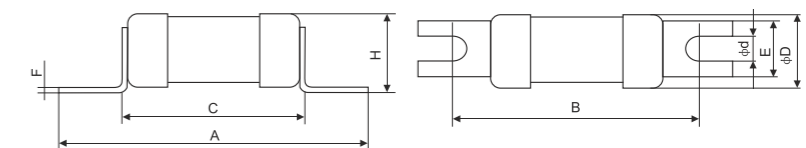

> 基本数据 Basic Data



序号 No.	产品型号 Product model	国内外同类产品 Domestic and oversea similar products	额定 电压 Rated Voltage (V)	额定 电流 Rated current (A)	外形尺寸 Overall dimension (mm)							
					A	B	C	ΦD	E	F	H	2-Φd
18101	RG11	RGS11	250/380	32	56	42	27.5	16.5	12.5	2	17.5	6.5x9
18102	RG4(Z)	RGS4(Z)	660/1000	63	77	62	49.5	16.5	12.5	2	18	6.5x9
18103	RG44(Z)	RGS44(Z)	500	100	94	72	49	32.5	25	2	21.5	11x14
18104	RG7(Z)	RGS7(Z)	500	100	113	94	68	34	19	2	35	9x11.5

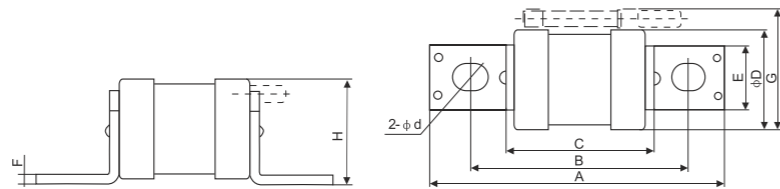

> 基本数据 Basic Data



序号 No.	产品型号 Product model	国内外同类产品 Domestic and oversea similar products	额定 电压 Rated Voltage (V)	额定 电流 Rated current (A)	外形尺寸 Overall dimension (mm)					
					A	B	C	D	F	G
18118	76JPU	RG8M	415/550	20-200	100	76	45	40	14	13
18119	82JPU	RG8M	415/550	200-400	111	82	45	40	14	17
18120	92JPU	RG8M	415/550	400-630	131	92	45	56	17	20

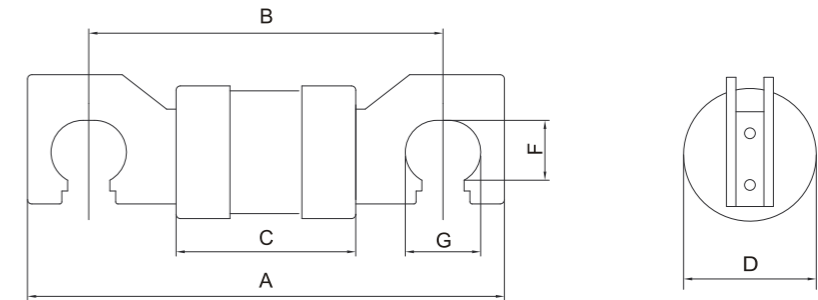

> 基本数据 Basic Data



序号 NO.	产品型号 Product model	额定电压 Rated Voltage (V)	额定 电流 Rated current (A)	外形尺寸 Overall dimension					
				A	B	ΦD	E	F	H
18105	F1 NS	550V/80KA	2-32	59		13.5	11	0.8	
18106	F1 NSB	550V/80KA	2-32	64		16	14.5	1	
18107	A1 NIT	550V/80KA	2-32	55	44.5	13.5	11	0.8	14.5
18108	A2 TIA	550V/80KA	2-63	86	73	22	13	1.2	24
18109	A2 TIS	550V/80KA	2-63	86	73	22	13	1.2	24
18110	A3 TCP	550V/80KA	40-100	110	94	27	19	2.0	28
18111	A4 TFP	550V/80KA	125-200	117	94	35	20	2.0	38
18112	B1	550V/80KA	2-63		111				
18113	B1 TBC	550V/80KA	2-63	137	111	22	15		
18114	B1 TC	550V/80KA	80-100						
18115	B2 TF	550V/80KA	125-200	137	111	38	18		
18116	B3 TKF	550V/80KA	-315	137	111	49	26		
18117	B4 TKM	550V/80KA	-400	137	111	56	26		

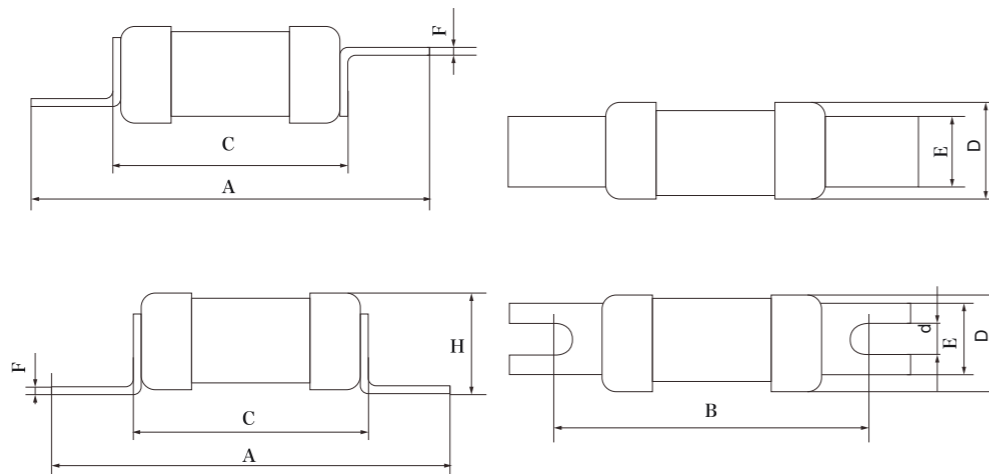

> 基本数据 Basic Data



序号 No.	产品型号 Product model	配套熔断体 Applicable fuse link	额定 电压 Rated Voltage (V)	额定 电流 Rated current (A)	外形尺寸 Overall dimension (mm)
18121	JPU FB	JPU	415/550	630	详细数据见下图 Refer to for detailed data

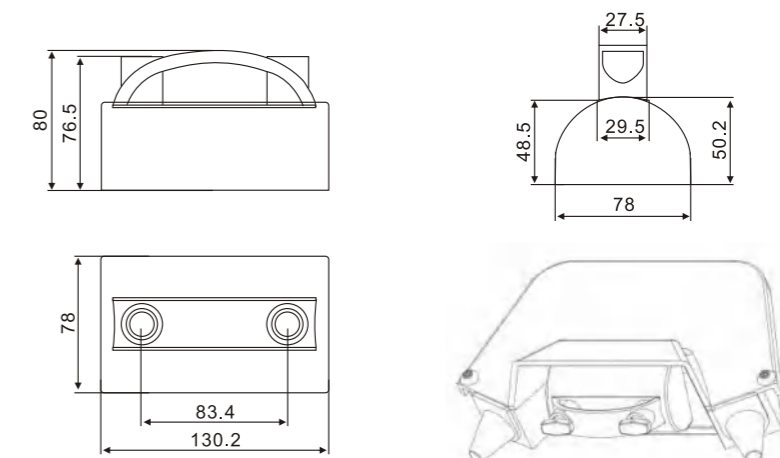

> 特性曲线 Characteristic curve

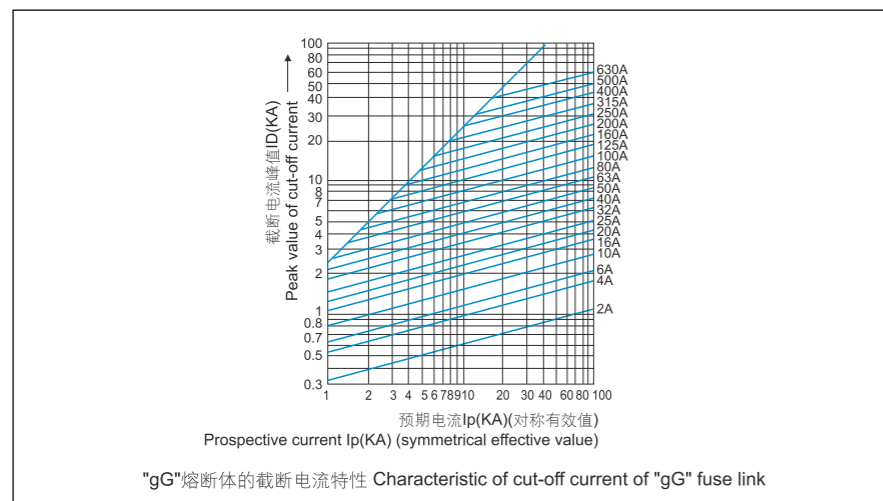
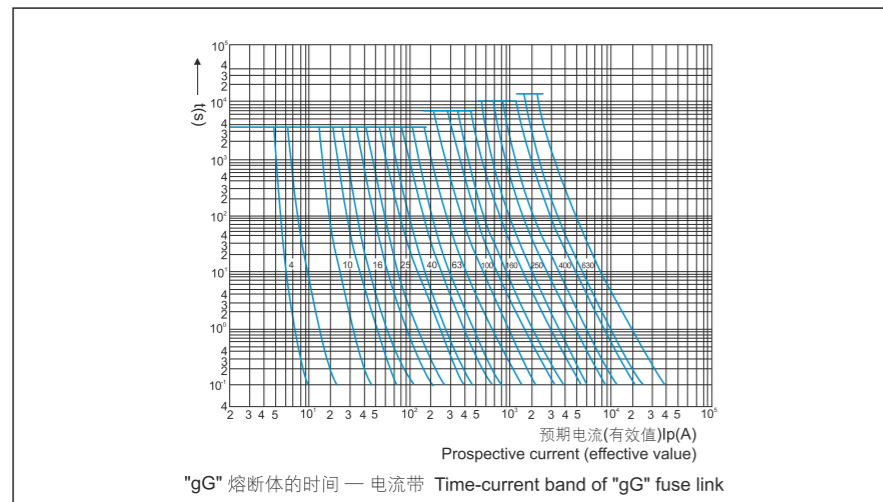
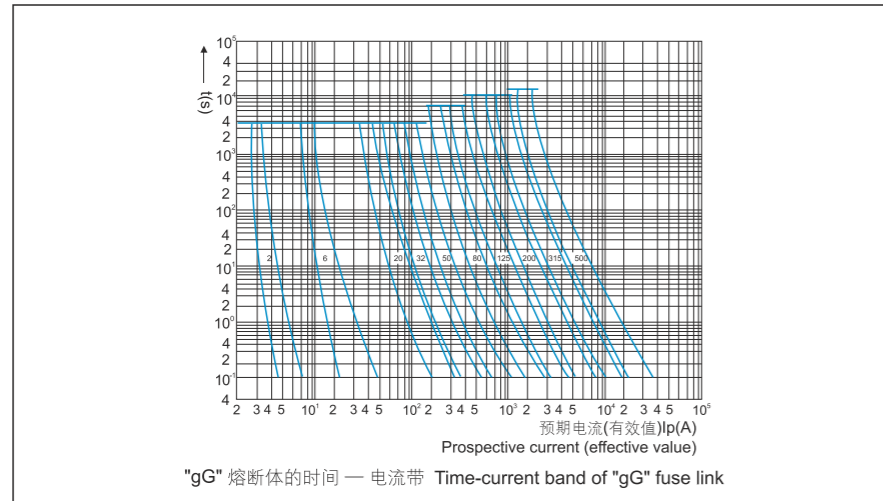

方管螺栓连接式熔断体
Bolt Connected Square Pipe Type Fuse Links



用途

本系列熔断体适用于交流 50Hz, 额定电压至 1000V、额定电流至 1250A, 主要用在电气线路中作为半导体器件及其成套装置的短路保护 (aR)。

本系列熔断体额定分断能力至 100KA。

本系列熔断体符合国家标准 GB13539.1、GB/T13539-4、GB/T13539.7 和国际电工委标准 IEC60269-1、IEC60269-4、IEC60269-4-1。

结构特点

由纯银片制成的变截面熔体封装于由高强度陶瓷制成的熔管内; 熔管中充满经化学处理过的高纯度石英砂作为灭弧介质; 熔体二端采用点焊与触头牢固电连接。熔断体型式有方管刀形触头和方管平板形触头两种。熔断体可带指示器或撞击器, 当熔体熔断时, 指示器/撞击器立即动作, 显示熔断体已熔断 (指示器) 并推动微动开关 (撞击器), 发出各种信号或自动切换电路。

基本数据

熔断体型号、外形尺寸、额定电压、额定电流参考基本数据。

Applications

This series of fuses are mainly used in circuits of AC 50Hz, rated voltage of 1000V and rated current of 1250A, to protect the semiconductor components and the whole unit from circuit short.(aR).

The breaking capacity of the fuses is up to 100KA.

The fuses are compliant with the IEC60269-1、IEC 60269-4、IEC60269-4-1 and GB13539.1、GB/T13539-4、GB/T13539.7 standards.

Design Features

The variable cross-section fuse element made from pure silver sheets are sealed in the melting tube made of high-density porcelain; The fuse tube is filled with chemically treated high-purity quartz as arc-extinguishing medium; The two ends of the melting body are connected to the (knife) contactor by dot welding; Both knife contactors and board contacts are available; A striker/indicator may be installed to the fuse link; When the fuse link breaks, signals are sent out in the case of an indicator, or the switch is pushed to cut the circuit in the case of a striker.

Basic Data

The model, outline dimension, rated voltage and rated current are shown in Figures.

> 基本数据 Basic Data



序号 No.	产品型号 Product model	国内外同类产品 Domestic and oversea similar products	额定 电压 Rated Voltage (V)	额定 电流 Rated current (A)	外形尺寸 Overall dimension (mm)							
					A	B	C	D	E	F	H	Φd
18122	NGT00	HLS00	380/800	32-160	100	77	50	29	27	2	51	11

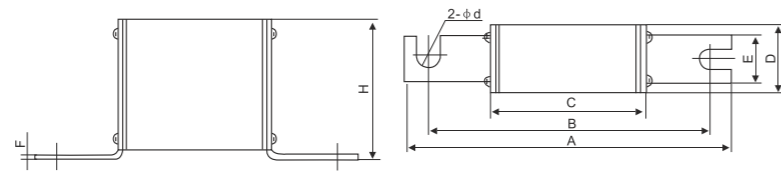

> 基本数据 Basic Data



序号 No.	产品型号 Product model	额定 电压 Rated Voltage	额定 电流 Rated current	外形尺寸 Overall dimension (mm)							
				A	B	C	D	E	F	H	Φd
18126	RS0(3)-100	250/500/750	60~100	140	120	70	40	20	2	43	7×10.5
18127	RS0(3)-200	250/500/750	120~200	145	120	72	46	29	3	50	9×13.5
18128	RS0(3)-400	250/500/750	200~400	150	120	72	55	30	3	60	9×13.5
18129	RS0(3)-600	250/500/750	300~600	155	120	76	66	40	5	72	13×19.5

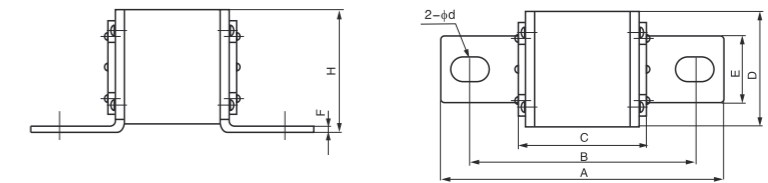

> 基本数据 Basic Data



序号 No.	产品型号 Product model	国内外同类产品 Domestic and oversea similar products	额定 电压 Rated Voltage (V)	额定 电流 Rated current (A)	外形尺寸 Overall dimension (mm)							
					A	B	C	D	E	F	Φd	
18123	NGT1	RS6-1	380/690/1000	458	140	110	68	48	25	6	10.5	
18124	NGT2	RS6-2	380/690/1000	654	140	110	68	58	32	6	10.5	
18125	NGT3	RS6-3	380/690/1000	900	140	110	68	67	38	6	10.5	

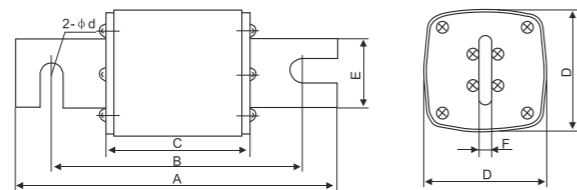

> 基本数据 Basic Data



序号 No.	产品型号 Product model	额定 电压 Rated Voltage (V)	额定 电流 Rated current (A)	外形尺寸 Overall dimension (mm)							
				A	B	C	D	E	F	H	Φd
18130	RS0-1000 RS3-1000	500~750	500~1000	173	136	76	85	50	5	91	17

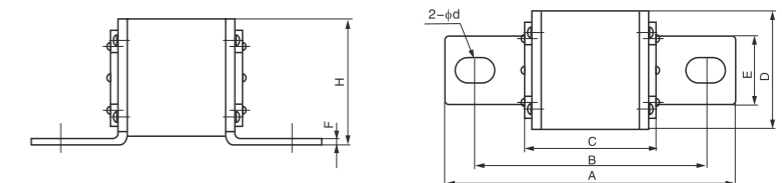



用途

本系列熔断体适用于交流50Hz、额定电压至1500V、额定电流至1250A，主要用在电气线路中作为半导体器件及其成套装置的短路保护(aR)。

本系列熔断体额定分断能力至100KA。

本系列熔断体符合国家标准 GB/T13539.1、GB/T13539.4、GB/T13539.7和国际电工委标准IEC60269-1、IEC60269-4、IEC60269-4-1。

结构特点

由纯银片制成的变截面熔体封装于由耐高温的环氧玻璃布管制成的熔管内；熔管中充满经化学处理过的高纯度石英砂作为灭弧介质；熔体两端采用点焊与触刀(头)牢固电连接。

基本数据

熔断体型号、外形尺寸、额定电压、额定电流参考基本数据。

Applications

This series of fuses are mainly used in circuits of AC 50Hz, rated voltage of 1500V and rated current of 1250 A, to protect the semiconductor components and the whole unit from short-circuit (aR)

The breaking capacity of the fuses is up to 100KA.

The fuses are compliant with the IEC60269-1、IEC 60269-4、IEC60269-4-1 and GB/T13539.1、GB/T13539.4、GB/T13539.7 standards.

Design Features

The variable cross-section fuse element made of pure silver sheets are sealed in the melting tube made of epoxy glass fibre which is heat resistant. The fuse tube is filled with chemically-treated high-purity quartz as arc-extinguishing medium. The two ends of the melting body are connected to the (knife) contacts by dot welding.

Basic Data

The model, outline dimension, rated voltage and rated current are shown in Figures.



> 基本数据 Basic Data

序号 No.	产品型号 Model of product	额定电压(V) Rated voltage (V)	额定电流(A) Rated current (A)	外形尺寸(mm) Overall dimension (mm)						
				A	B	C	φD	E	F	φd
18131	RS94A	500	40-200	70	52	32	28	22	5	8.2×12
18132	RS94C	500	40-200	80	62	42	28	22	5	8.2×12
18133	RS94D	250	30-200	80	57	26	29	22	5	8.2×12
18134	RS94E	500	30-200	80	60	42	31	24	5	8.2×12
18135	RS94F	500	40-200	80	58	38	33	25	5	8.2×12
18136	RS94G	500	40-400	88	62	42	36	26	5	10.2×15
18137	RS94H	250	30-150	70	53	27	22	16	5	8.2×12
18138	RS94J	250	40-250	67	51	26	26	19	3.5	8.2×12
18139	RS95A	500/660	50-250	91	72	54	28	22	5	8.2×12
18140	RS95B	500/660	50-300	92	73	54	31	25	5	8.2×12
18141	RS95C	500/660	50-200	92	73	54	26	19	5	8.2×12
18142	RS95D	500/660	100-200	92	72	45	30	25	5	8.2×12
18143	RS95E	500/660	40-350	92	72	54	31	25	6	8.2×12
18144	RS95F	500/660	50-250	93	75	54	26	19	5	8.2×12
18145	RS95FS	500	100	100	82	48	26	19	3	8.2×12
18146	RS95G	500/660	50-300	93	75	53	31	25	5	8.2×10
18147	RS95H	500	200-400	96	70	42	36	26	5	10.2×15
18148	RS95K	500	250-400	98	70	38	47	32	5	10.2×15
18149	RS95L	700	100-300	127	108	89	31	25	5	8.2×12
18150	RS95M	500	50-200	110	81	50	31	25	5	8.2×10
18151	RS95N	700	50-200	128	101	75	25	20	6	10.5×15
18152	RS95P	250	250-400	98	68	41	38	25	6	10.5×18
18153	RS95Q	500	50-200	110	95	75	25	18	5	6.2×10
18154	RS95R	700	35-100	110	84	50	31	25	6	8.2×18
18155	RS95S	250	160-300	100	65	30	36	30	6	10.5×15
18156	RS95T	500/660	100-250	112	87	52	27	21	5	10×18
18157	RS95U	500	100	100	82	48	26	19	5	8.2×12
18158	RS95V	600	100-200	128	98	60	25	19	3	10.2×15
18159	RS95W	500	40-200	129	96	53	34	24	6	12×20
18160	RS96A	500	200-300	100	70	40	40	26	6	10.5×18
18161	RS96B	500/660	200-400	110	83	53	38	26	6	8.2×12
18162	RS96C	500/660	100-200	112	90	70	25	20	6	10.5×15
18163	RS96D	500/660	75-200	112	90	60	36	26	5	10.5×15
18164	RS96E	500/660	200-300	112	93	73	31	25	5	7×9.5
18165	RS96F	500/660	200-400	113	87	70	40	26	6	10.5×15
18166	RS96G	500/660	400-500	114	87	56	51	38	6	10.5×15
18167	RS96GK	500	400-500	97	67	38	51	36	8	11×17
18168	RS96H	500/660	300	117	92	67	28	22	3	7×9.5
18169	RS96K	500/660	200-400	117	80	52	40	32	6	10.5×15
18170	RS96L	500/660	200-400	117	89	57	37	30	6	10.5×15
18171	RS96M	500	50-200	135	113	67	34	20	5	8.2×12
18172	RS96N	500	250-400	115	87	58	39	26	6	10.5×18
18173	RS96P	700	125-200	130	90	50	38	25	6.3	10.5×26
18174	RS96Q	250	315-400	100	71	38	43	35	9	10.5×15
18175	RS96R	500/660	35-300	113	83	53	40	30	6.5	12.2×18
18176	RS96S	500/660	40-250	95	68	40	27	20	5	9×18
18177	RS97A	500/660	300-500	120	90	58	46	32	6	10.5×18
18178	RS97B	500/660	50-200	126	100	74	38	26	6	10.5×18
18179	RS97C	500/660	350-500	128	98	70	51	38	6	10.5×18
18180	RS97D	500/660	200-400	130	98	72	38	26	6	10.5×18
18181	RS97E	500/660	200-350	145	111	77	38	29	5	7×11
18182	RS97F	500/660	200-400	145	105	76	41	28	8	10.5×18

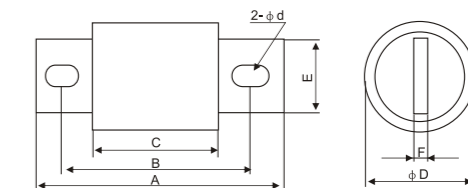

> 基本数据 Basic Data



序号 No.	产品型号 Model of product	额定电压(V) Rated voltage (V)	额定电流(A) Rated current (A)	外形尺寸(mm) Overall dimension (mm)						
				A	B	C	φD	E	F	φd
18183	RS97G	500/660	200~400	146	110	76	41	29	5	7×9.5
18184	RS97H	500/660	200~400	146	110	75	48	36	8	12.5×18
18185	RS97K	500/660	200~400	130	100	70	53	42	8	14.2×18
18186	RS97L	500	200~400	125	103	48	51	38	6	10.5×18
18187	RS97M	500	400~500	145	102	53	51	38	6.3	14.5×30
18188	RS97N	500/660	200~400	145	113	88	38	25	6.3	10.5×18
18189	RS98A	500/660	600	165	114	56	64	50	8	10.5×18
18190	RS98B	500/660	600	170	130	80	70	50	6	10.5×18
18191	RS98C	500/660	500	181	133	86	51	40	10	10.5×15
18192	RS98D	500/660	600	180	131	85	64	50	10	14.2×18
18193	RS98E	700	250~400	130	90	50	51	38	6.3	14.2×28
18194	RS98F	700	300~400	181	130	72	64	50	10	14.2×28
18195	RS98G	700	400~600	175	135	73	63	51	10	12.5×18
18196	RS98H	700	400~500	166	118	70	50	38	6	16.2×22
18197	RS98K	700	500~600	181	114	50	64	51	9.5	14.2×45
18198	RS98L	700	500~800	167	137	72	70	50	8	10.5×18
18199	RS98M	700	500~600	160	108	53	63	50	9	14.2×23
18200	RS98N	700	500~600	180	125	73	60	46	13	14.2×25
18201	RS98P	500	400~500	110	80	53	50	40	6	10.5×18
18202	RS99A	500/660	500~600	190	140	90	65	50	10	14.2×18
18203	RS99B	500/660	400~600	203	152	95	64	50	10	10.5×18
18204	RS99C	500/660	400~600	217	157	101	60	50	12	16.2×28
18205	RS99D	500	800~1000	180	127	85	76	61	11.3	16.2×22
18206	RS99E	700	800~1250	200	150	100	90	70	13	20.5×30
18207	RS99F	700	400~600	180	129	72	64	51	9.5	13.5×18
18208	RS99G	700	800~1000	195	150	95	75	61	10	13×18
18209	RS99H	500	500~600	145	130	46	52	38	8	15×29
18210	RS99J	500	400~600	175	123	70	65	50	10	14.2×30
18211	RS99K	500	400~600	181	133	72	64	51	10	13×33
18212	RS99L	500	400~600	175	125	71	65	50	10	14.2×33

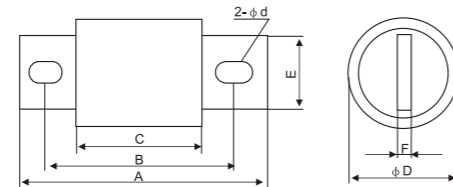

> 基本数据 Basic Data



序号 No.	产品型号 Model of product	额定电压(V) Rated voltage (V)	额定电流(A) Rated current (A)	外形尺寸(mm) Overall dimension (mm)
18213	RS94B	500	40~100	详细数据见图 Refer to drawing for detailed data

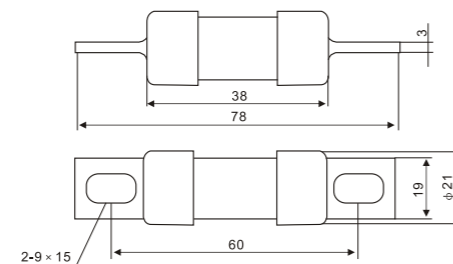

> 特性曲线 Characteristic curve

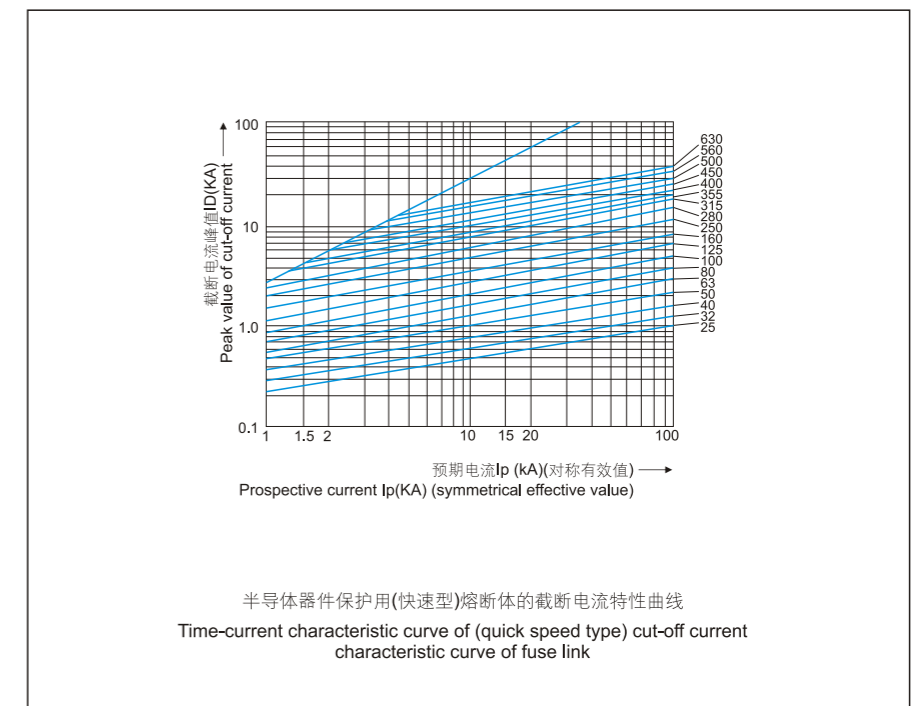
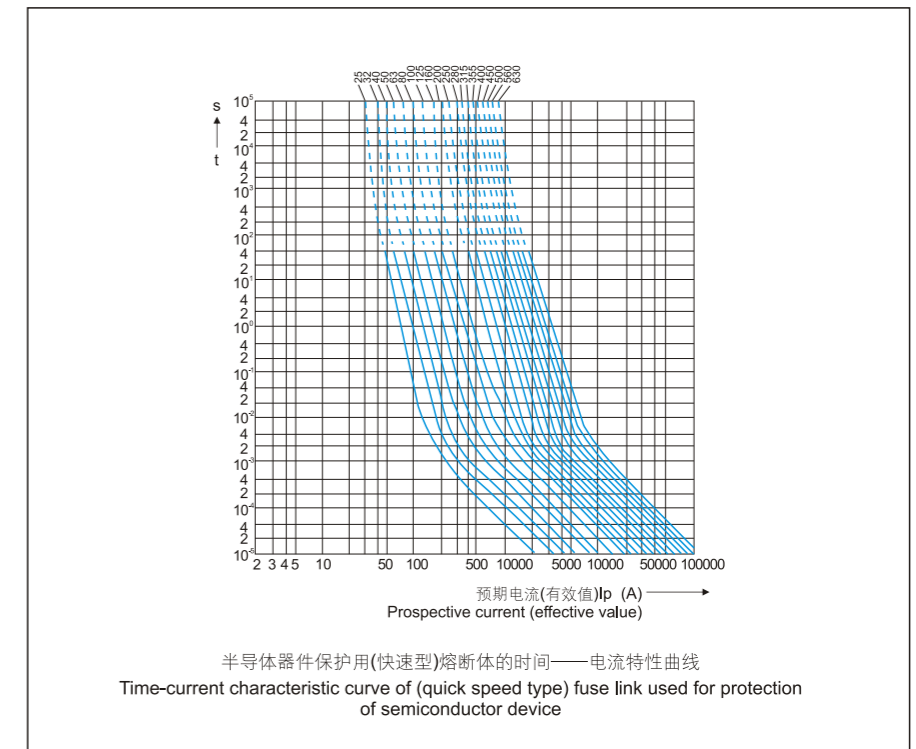

**有填料方管螺栓形交直流熔断体
Filled Square Bolted Type AC/DC Fuse Link**



本公司580M快速熔断器，实现了100%的国产化制造，具有aR全范围保护特性，做电力系统的过载和短路保护，该系列产品特性同等于170M、RSF、RS4、RS8、RSH、RSG、RST、RSM等的同类进出口产品，与国外熔断器保持相同的电气保护特性和互换安装尺寸，是我国电网实现国产化的关键器件之一。

The 580M series fuse is made in domestic 100%, with the protective features of aR, and it is used for protecting the power system from overload and short-circuit. This series products are equal to the same type of products 170M, RSF, RS4, RS8, RSH, RSG, RST, RSM. It keeps the same electrical protection features with the foreign fuse, and can swap installation dimensions. It is one of the key components that China power grid could realize localization.

> 用途 Application

本系列熔断体适用于交流50HZ、额定电压至2000V、额定电流至3000A、主要用在电气线路中作为半导体设备的短路保护（aR），本系列产品符合国际及国家标准IEC60269和GB13539的规定。

This series of fuse links is mainly used in AC 50Hz. Rated voltage up to 2000V, rated current up to 3000A, and for overload and short-circuit protection in power systems (aR). This series of fuse links conform to GB13539, and IEC60269 standards.

> 工作条件 Usual Service Condition

周围空气温度上限不超过80℃；周围空气温度下限不低于-40℃；安装地点的海拔不超过2000m(如若要超过此2000m，需要注明要求，本公司可以按照客户要求设计开发)。

Ambient Temperature: -40℃~+80℃
Equipment installation height: less than 2000m (If exceeding this value, please specify the requirements, and company will design according to the requirements)

> 应用类别 Application Category

gR/aR表示全范围或者部分范围保护用熔断体
gR/aR means fuse with full range protection or partial range protection.

> 结构特点 Construction Feature

本系列产品采用99.99%纯银片制成的变截面熔体封装于由95%AL₂O₃高强度瓷制成的熔管内，熔管中充满经化学处理过的高纯度石英砂和特殊处理化学物质作为灭弧介质，接触面采用镀银处理，熔体两端采用点焊与触头牢固电连接。

The fusing element of this series fuse is made by pure silver with purity of 99.99%, and hermetically assembled in fuse tube made from high-strength porcelain in 95% of AL₂O₃, and the fuse tube is filled with chemically treated high-purity quartz sands as arc-extinguishing medium; contact surface is by silver-plating; both ends of the fuse body are connected with the copper and contacts hardly by spot welding.

型号说明

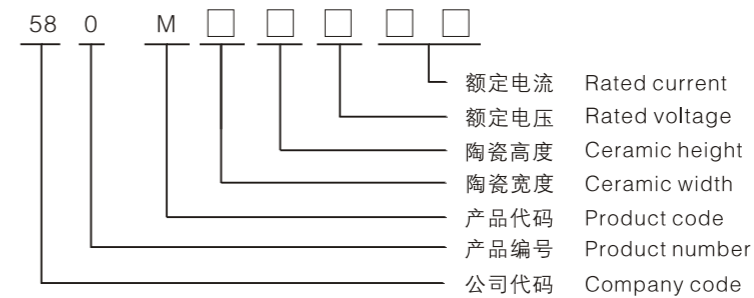

> 安装形式 Installation Form

- M 铜头平板式
- Z 触刀插入式
- L 弯母线式
- H 纯平板式
- T 平板直脚母线式
- MZ 触刀直母线式(一直一弯两开孔)
- MB 触刀直母线式(两长圆孔)
- ME 触刀直母线式(两长圆开孔,孔径向下)
- MU 触刀直母线式(两长圆开孔,孔径相反)

> 陶瓷规格 Ceramic Specification

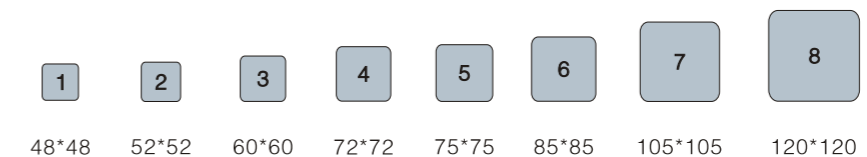

代码 Code	额定电流 Rated current (A)	熔断体型号 Fuse model				
		H=40 Un≤690V (表1)	H=60 Un≤690V (表2)	H=60 690V < Un ≤1000V 表(2)	H=70 Un≤690V (表3)	H=70 690V < Un ≤1000V (表3)
1	30	580M12216	580M14216	580M14316		
	40	580M12218	580M14218	580M14318		
	50	580M12220	580M14220	580M14320		
	63	580M12223	580M14223	580M14323		
	80	580M12225	580M14225	580M14325		
	100	580M12227	580M14227	580M14327		
	125	580M12228	580M14228	580M14328		
	160	580M12230	580M14230	580M14330		
	200	580M12232	580M14232	580M14332		
	225	580M12233	580M14233	580M14333		
	250	580M12234	580M14234	580M14334		
	300	580M12236	580M14236	580M14336		
	315	580M12237	580M14237	580M14337		
	350	580M12239	580M14239	580M14339		
	400	580M12240	580M14240	580M14340		
	2	200	580M22232	580M24232	580M24332	
225		580M22233	580M24233	580M24333		
250		580M22234	580M24234	580M24334		
300		580M22236	580M24236	580M24336		
315		580M22237	580M24237	580M24337		
350		580M22239	580M24239	580M24339		
400		580M22240	580M24240	580M24340		
450		580M22241	580M24241	580M24341		
500		580M22242	580M24242	580M24342		
550		580M22243	580M24243	580M24343		
600		580M22244	580M24244	580M24344		
630		580M22245	580M24245	580M24345		

代码 Code	额定电流 Rated current (A)	熔断体型号 Fuse model				
		H=40 Un≤690V (表1)	H=60 Un≤690V (表2)	H=60 690V < Un ≤1000V (表2)	H=70 Un≤690V (表3)	H=70 690V < Un ≤1000V (表3)
3	350	580M32239	580M34239	580M34339		
	400	580M32240	580M34240	580M34340		
	450	580M32241	580M34241	580M34341		
	500	580M32242	580M34242	580M34342		
	550	580M32243	580M34243	580M34343		
	600	580M32244	580M34244	580M34344		
	630	580M32245	580M34245	580M34345		
	710	580M32247	580M34247	580M34347		
	750	580M32248	580M34248	580M34348		
	800	580M3249	580M34249	580M34349		
	4	600	580M42244	580M44244	580M44344	580M45244
630		580M42245	580M44245	580M44345	580M45245	580M45345
710		580M42247	580M44247	580M44347	580M45247	580M45347
750		580M42248	580M44248	580M44348	580M45248	580M45348
800		580M42249	580M44249	580M44349	580M45249	580M45349
900		580M42251	580M44251	580M44351	580M45251	580M45351
1000		580M42252	580M44252	580M44352	580M45252	580M45352
1200		580M42254	580M44254	580M44354	580M45254	580M45354
5	630	580M52245	580M54245	580M54345	580M55245	580M55345
	700	580M52246	580M54246	580M54346	580M55246	580M55346
	750	580M52248	580M54248	580M54348	580M55248	580M55348
	800	580M52249	580M54249	580M54349	580M55249	580M55349
	900	580M52251	580M54251	580M54351	580M55251	580M55351
	1000	580M52252	580M54252	580M54352	580M55252	580M55352
	1100	580M52253	580M54253	580M54353	580M55253	580M55353
	1200	580M52254	580M54254	580M54354	580M55254	580M55354
	1250	580M52255	580M54255	580M54355	580M55255	580M55355

代码 Code	额定电流 Rated current (A)	熔断体型号 Fuse model					
		H=40 Un≤690V (表1)	H=60 Un≤690V (表2)	H=60 690V < Un ≤1000V (表2)	H=70 Un≤690V (表3)	H=70 690V < Un ≤1000V (表3)	
6	750	580M62248	580M64248	580M64348	580M65248	580M65348	
	800	580M62249	580M64249	580M64349	580M65249	580M65349	
	900	580M62251	580M64251	580M64351	580M65251	580M65351	
	1000	580M62252	580M64252	580M64352	580M65252	580M65352	
	1100	580M62253	580M64253	580M64353	580M65253	580M65353	
	1200	580M62254	580M64254	580M64354	580M65254	580M65354	
	1300	580M62256	580M64256	580M64356	580M65256	580M65356	
	1400	580M62257	580M64257	580M64357	580M65257	580M65357	
	1500	580M62258	580M64258	580M64358	580M65258	580M65358	
	1600	580M62259	580M64259	580M64359	580M65259	580M65359	
	7	1000	580M72252	580M74252	580M74352	580M75252	580M75352
		1100	580M72253	580M74253	580M74353	580M75253	580M75353
1200		580M72254	580M74254	580M74354	580M75254	580M75354	
1250		580M72255	580M74255	580M74355	580M75255	580M75355	
1300		580M72256	580M74256	580M74356	580M75256	580M75356	
1400		580M72257	580M74257	580M74357	580M75257	580M75357	
1500		580M72258	580M74258	580M74358	580M75258	580M75358	
1600		580M72259	580M74259	580M74359	580M75259	580M75359	
1700		580M72260	580M74260	580M74360	580M75260	580M75360	
1800		580M72261	580M74261	580M74361	580M75261	580M75361	
1900		580M72262	580M74262	580M74362	580M75262	580M75362	
2000		580M72263	580M74263	580M74363	580M75263	580M75363	
2100		580M72264	580M74264	580M74364	580M75264	580M75364	
2200		580M72265	580M74265	580M74365	580M75265	580M75365	
2300		580M72266	580M74266	580M74366	580M75266	580M75366	
2400		580M72267	580M74267	580M74367	580M75267	580M75367	
2500	580M72268	580M74268	580M74368	580M75268	580M75368		

代码 Code	额定电流 Rated current (A)	熔断体型号 Fuse model				
		H=40 Un≤690V (表1)	H=60 Un≤690V (表2)	H=60 690V < Un ≤1000V (表2)	H=70 Un≤690V (表3)	H=70 690V < Un ≤1000V (表3)
8	1000	580M82252	580M84252	580M84352	580M85252	580M85352
	1250	580M82255	580M84255	580M84355	580M85255	580M85355
	1300	580M82256	580M84256	580M84356	580M85256	580M85356
	1400	580M82257	580M84257	580M84357	580M85257	580M85357
	1500	580M82258	580M84258	580M84358	580M85258	580M85358
	1600	580M82259	580M84259	580M84359	580M85259	580M85359
	1700	580M82260	580M84260	580M84360	580M85260	580M85360
	1800	580M82261	580M84261	580M84361	580M85261	580M85361
	1900	580M82262	580M84262	580M84362	580M85262	580M85362
	2000	580M822063	580M984263	580M84363	580M85263	580M85363
	2100	580M82264	580M84264	580M84364	580M85264	580M85364
	2200	580M82265	580M84265	580M84365	580M85265	580M85365
	2300	580M82266	580M84266	580M84366	580M85266	580M85366
	2400	580M82267	580M84267	580M84367	580M85267	580M85367
	2500	580M82268	580M84268	580M84368	580M85268	580M85368
	2600	580M82269	580M84269	580M84369	580M85269	580M85369
	2700	580M82270	580M84270	580M84370	580M85270	580M85370
	2800	580M82271	580M84271	580M84371	580M85271	580M85371
	2900	580M82272	580M84272	580M84372	580M85272	580M85372
	3000	580M82273	580M84273	580M84373	580M85273	580M85373

表1

代码Code	A	B	C	D	M × H
1	56	48	60	4	8 × 10
2	56	52	64	24	8 × 10
3	56	60	72	30	10 × 10
4	56	72	85	40	10 × 10
5	56	75	88	45	12 × 12
6	60	85	98	53	12 × 12
7	60	105	118	70	16 × 14
8	60	120	133	84	16 × 14

表2

代码 Code	A	B	C	E	M × H
1	76	52	64	24	8 × 10
2	76	60	72	30	10 × 10
3	76	72	85	40	10 × 10
4	76	75	88	45	12 × 12
5	78	85	98	53	12 × 12
6	80	105	118	70	16 × 14
7	80	120	133	84	16 × 14

表3

代码 Code	A	B	C	E	M × H
1	86	75	88	45	12 × 12
2	88	85	98	53	12 × 12
3	89	105	118	70	16 × 14
4	90	120	133	84	16 × 14

> 基本数据 Basic Data

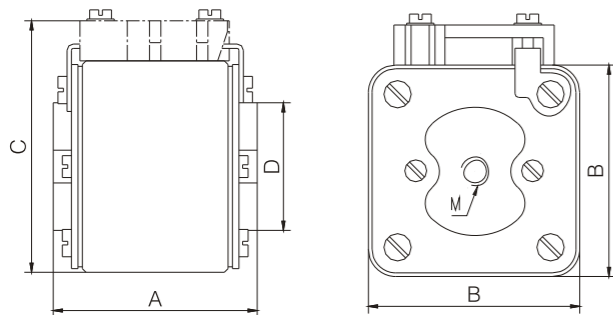

> “aR” 基本数据 Characteristic Curve of “aR” Fuse Link

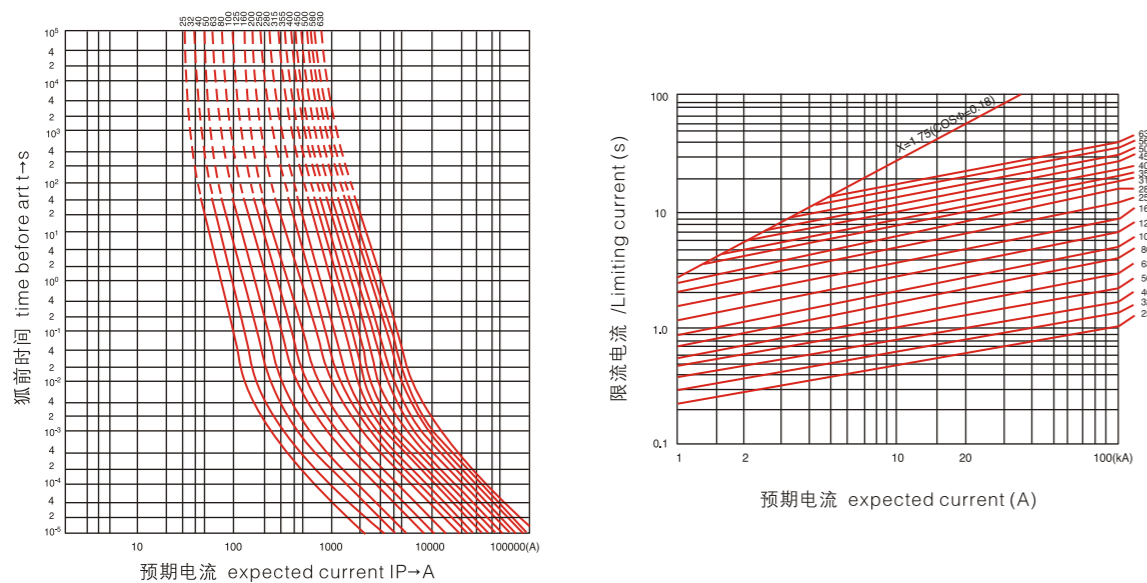

有填料汽车用交直流熔断体
Filled Auto AC/DC Fuse Link



本系列汽车用熔断器适用于额定电压直流48V或交流（50Hz）至125V、额定电流至800A,主要作为电气线路的过载和短路保护。

Protection against overloads and circuit short in electric lines. Rated voltage up to 48VDC or 50Hz 125V AC; Rated current up to 800A

> 结构特点 Construction Feature

本系列汽车用熔断器由二部分组成---熔断体和熔断器座。熔断体按不同使用要求分为普通型（CNT、RQ1）和快速型（CNN）二种，均为螺栓连接式。熔断器可以直接与母线连接，省去一个熔断器座；也可以将熔断体固定在一个以安装好的熔断器座（RQD-1）上，更换熔断体比较方便。

This series of vehicle fuses are made up with two parts: fuse link and fuse base. According to different applications, the fuse links can be divided into normal type (CNT, RQ1) and fast type (CNN), both are bolting connected. The fuse links can be connected directly to the bus bar for saving a fuse base. It can also be fastened to an installed fuse base (RQD-1) for convenient fuse exchange.

产品型号 Fuse model	产品名称 Product name	额定电压 Rated voltage (V)	额定电流 Rated current (A)	重量 Weight (G)	外形尺寸/尺码(mm) Overall dimension/size
RQ1	熔断体 fuse link	DC48/AC125	60~800	54	详细数据见下图 (Dimension as drawing)
CNL	熔断体 fuse link	DC48/AC125	35~250	32	
				30	
			275~500	68	
			600~750	258	
				255	

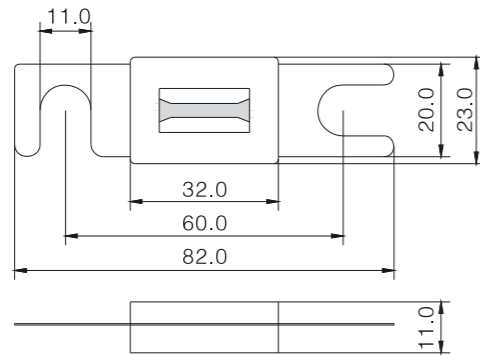

产品型号 Fuse model	产品名称 Product name	额定电压 Rated voltage (V)	额定电流 Rated current (A)	重量 Weight (G)	外形尺寸/尺码(mm) Overall dimension/size
RQD-1	熔断器座 fuse base	AC220	800	139	详细数据见下图 (Dimension as drawing)

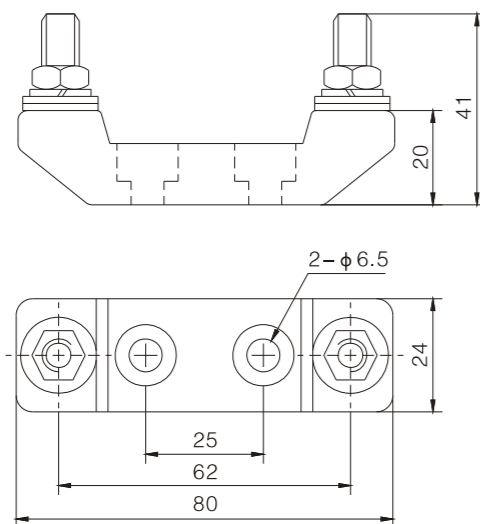

用途

本系列熔断报警器适用于交流50Hz、额定电压至1000V的电气线路中作为熔断体的熔断信号/报警之用。

结构特点

本系列熔断报警器由下列三部份组成:

1. 熔断撞击体
2. 微动开关 (触头为一常开一常闭)
3. 支持熔断撞击体和微动开关用的底座

熔断报警器一般并联在熔断体两端盖板固定螺钉下, 当熔断体熔断时, 熔断撞击体紧接着动作, 弹出撞针, 推动微动开关, 发出信号或自动切换电路。底座上下两固定(接触)端之间距离可在一定范围内调节, 以适应不同高度的熔断体并联(固定)之用。

基本数据

熔断体型号、外形尺寸、额定电压、额定电流参考基本数据。

Applications

This series of fuse alarms are used in electric lines of 50 Hz AC and rated voltage up to 1000V as melting signal/ and giving an alarm.

Design Features

It is made up of the following parts: 1.Melt striker; 2. Micro switch (with one normal close contact and one normal open contact); 3. A base for the striker and the switch.

Fuse alarms are usually paralleled under the lid fastening screws at the ends of the fuse. When the fuse breaks, the striking pin springs out of the striker, the microswitch pushed and signal sent out or circuit cut down. The distance between the two fastening ends can be adjusted in a certain range for paralleling to fuses with different heights.

Basic Data

The model, outline dimension, rated voltage and rated current are shown in Figures.

基本数据 Basic Data



序号 No.	产品型号 Product model	产品名称 Product name	额定绝缘 电压 (V) Rated insulation Voltage (V)	外形尺寸 Overall dimension (mm)				
				A	d	D	L1	L2
18214	RX1-1000	熔断撞击体 Fuse striker	1000	7.5	7.5	11	82	89
18215	RX1-2000							
18216	RZS1-1000	熔断撞击体 Fuse striker	1000	12	5	11	58	64
18217	RX1A-1000							

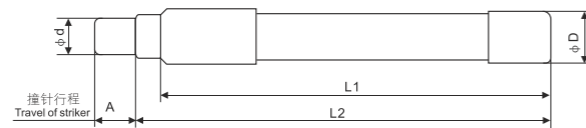

用途

本载熔件(手柄)适用于各种尺码的刀型触头熔断体在相应底座上装卸之用。额定绝缘电压交流50HZ, 1000V。具有绝缘可靠、使用安全、操作灵活方便等优点。

结构特点

载熔件由搭扣、按钮、挡板、手柄等组成,搭扣分三档尺寸,分别可载扣 RT16、NT、NH、RTO 等各种尺码的熔断体。

基本数据

产品型号、额定绝缘电压、外形尺寸参考基本数据图。

Applications

The fuse carrier is used for loading and unloading on corresponding base for knife type contact fuse links of various sizes in AC 50Hz and rated voltage up to 1000V. It is featured with reliable insulating, safe using and flexible operation and so on.

Design Features

The fuse carrier is made up of catching holes, push button, guard board and handle, There are three position for the catching holes for RT16, NT, NH, and RTO fuses.

Basic Data

The model, outline dimension, rated voltage and rated current are shown in Figures.

基本数据 Basic Data



序号 No.	产品型号 Product model	产品名称 Product name	额定绝缘 电压 Rated insulation Voltage (V)	外形尺寸 Overall dimension (mm)				
				A	d	D	L1	L2
18218	RX1-1000	熔断撞击体底座 Base of fuse striker	1000	41~88	22.5	27	54.5	114
18219	RX2-1000							
18220	RZS1-1000	熔断撞击体底座 Base of fuse striker	1000	30~72	26	28	36.5	90
18221	RX1A-1000							

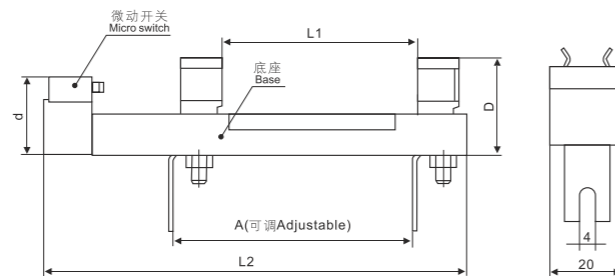

基本数据 Basic Data



序号 No.	产品型号 Product model	额定绝缘 电压 Rated insulation Voltage (V)	外形尺寸 Overall dimension (mm)
18222	RT16/NT/NH	1000	详细数据见下图 Refer to drawing for detailed data

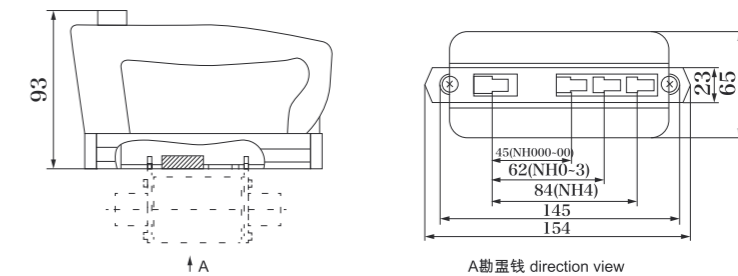

> 隔离开关简介 Switch Profile

HR17B系列熔断器式隔离开关可带负荷操作，适用于额定电流40A~1600A，有1组、2组、3组、4组之分。既可安装在母线上，也可安装在固定板上；并提供了上下端输入输出结构，带刀口引入及灭弧装置；且开关罩上不定期有封闭的检测孔，内置信号开关、检测开关。可选配熔丝监测器，亦可做刀关使用。开关造型美观、新颖简洁，符合IEC60947-3、GB14048.3标准。

HR17B series fuse-type disconnectors with load operation, suitable for rated current 40A ~ 1600A, there are 1 group, 2 groups, 3 groups, 4 groups of points. It can be mounted on the busbar, can also be installed in the fixed plate; it provides the upper and lower input and output structure, with a knife-edge introduction and arc-control device; and the switch cover has irregular closed detection holes, built-in signal switch, detection switch. it can be optional fuse monitor, can also be used as knife switch. The switch with beautiful shape, novel and concision, it meets the IEC60947-3, GB14048.3 standards.

> 型号及含义 Model and implication



> 主要技术参数 Main technical parameters

型号 Model	HR17-160	HR17-250	HR17-400	HR17-630
额定绝缘电压 U_i	690V	690V	690V	690V
额定工作电压 U_e	400V	400V	400V	400V
额定工作电流 I_e	160A	250A	400A	630A
额定短路接通能力 L_{cm}	1600A	2500A	4000A	6300A
额定限制短路电流 L_{nc}	50kA	50kA	50kA	50kA
使用类别 Category	AC-23B	AC-23B	AC-23B	AC-23B
配用熔断器 Applicable fuse	NT00	NT1	NT2	NT3

> 基本数据 Basic Data



序号 No.	产品型号 Product model	可装配熔断器型号 尺码、规格 Model, size and specification of applicable fuse link	额定绝缘电压 (V) Rated insulation Voltage (V)	外形尺寸 Overall dimension (mm)			
				A	B	C	D
18223	HR17-160	NT00/00C NH00 00C RT16-00/000	690	160	200	83	205
18224	HR17-250	NT1 NH1 RT16-1	690	185	247	110	295
18225	HR17-400	NT2 NH2 RT16-2	690	210	290	125	340
18226	HR17-630	NT3 NH3 RT16-3	690	256	300	145	360

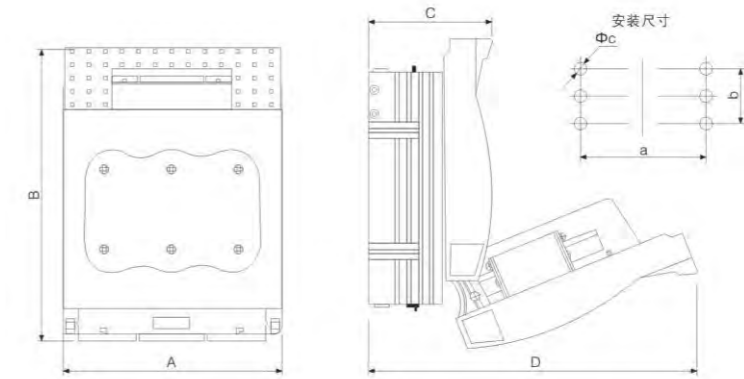

> 基本数据 Basic Data



序号 No.	产品型号 Product model	可装配熔断器型号 尺码、规格 Model, size and specification of applicable fuse link	额定绝缘电压 Rated insulation Voltage (V)	额定电流 Rated current (A)	外形尺寸 Overall dimension (mm)
18227	CUT OUT-63	Φ 22x58	415	25-63	详细数据见图 Refer to drawing for detailed data
18228	CUT OUT-125	Φ 30x58	415	80-125	
18229	CUT OUT-63+N	Φ 22x58	415	25-63	
18230	CUT OUT-125+N	Φ 30x58	415	80-125	

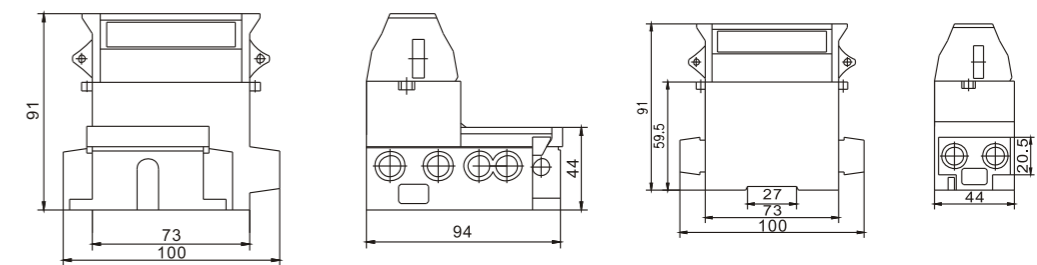

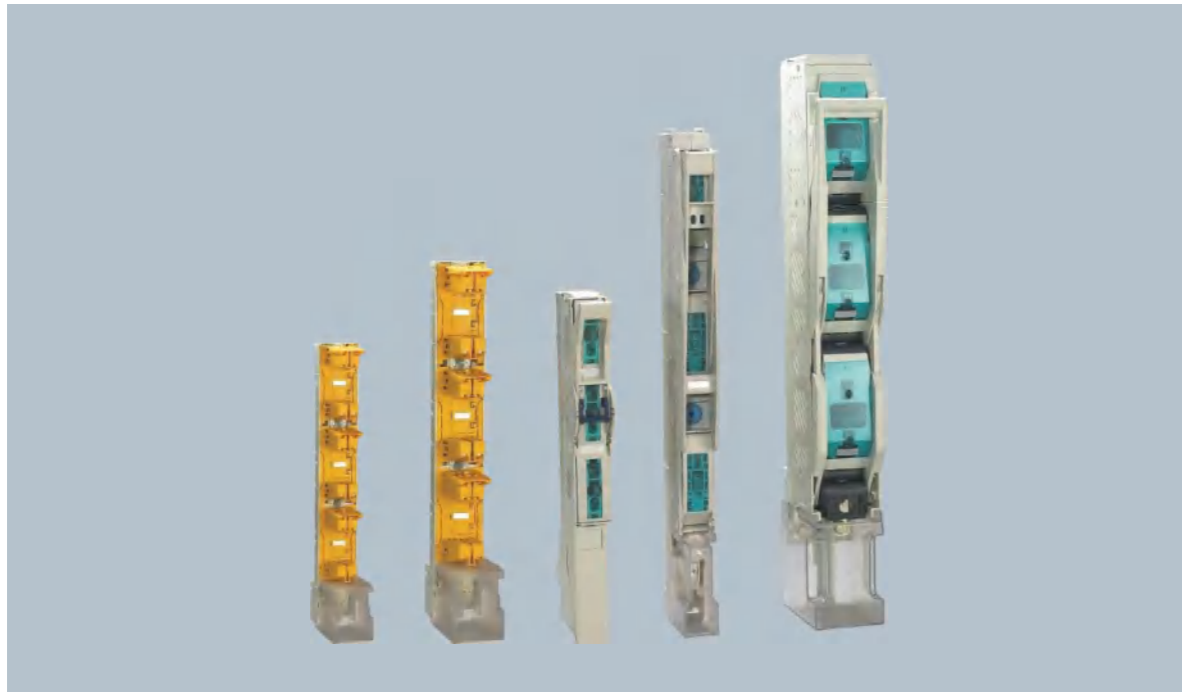

用途

本系列熔断器底座适用于交流50Hz,额定绝缘电压至690V、额定电流至630A,100mm或185mm母线系统。作为电路过载及保护之用,广泛应用于箱变、电缆分支箱。产品符合GB13539, GB14048, IEC60269, IEC60947

结构特点

该产品是用于安装在总线轨道上的3条条形熔断器底座。它将3只纵向排列的单极熔断器座容为一体,每相的一个触点(馈电触点)与一个相联接,其他触点(输出端触点)配装导线连接装置。底座由坚固的玻璃纤维加强聚酯材料制成。熔断器触点与引线板一起确保产品的能耗小;接受功率大;温升低。

基本数据

熔断体型号、外形尺寸、额定绝缘电压、额定电流参考基本数据。

Applications

This series fuse base is suitable for AC 50Hz, rated insulation voltage up to 690V, rated current up to 630A, 100mm or 185mm bus system. As a circuit overload and protection, it is widely used in box change and cable branch box. Products comply with GB13539, GB14048, IEC60269, IEC60947 standards.

Design Features

The product is the 3 bar fuse base mounted on the bus track. The utility model combines 3 longitudinal arranged unipolar fuse holders into an integral body, an electric shock (feeding, electric shock) is connected with one phase of each phase, and other contacts (output ends and contacts) are connected with a wire connecting device. The base is made of strong fiberglass reinforced polyester material. Fuse contacts and lead plate together to ensure that the product energy consumption is small; acceptance power is large; low temperature rise.

Basic Data

The model, outline dimension, rated voltage and rated current are shown in Figures.

> 主要技术参数 Main technical parameters

型号Model	CFHR160L	CFHR250L	CFHR400L	CFHR630L
额定绝缘电压Ui	1000V	1000V	1000V	1000V
额定工作电压Ue	690V	690V	690V	690V
额定工作电流Le	160A	250A	400A	630A
额定频率Hz	50/60	50/60	50/60	50/60
额定冲击耐受电压Uimp	10kA	10kA	10kA	10kA
使用类别Category	AC-23B	AC-23B	AC-23B	AC-23B
接线规格Wire specifications	70mm ²	120mm ²	240mm ²	300mm ²
防护等级Degress of protection	IP30	IP30	IP30	IP30
配用熔断器Applicable fuse	NT00	NT1	NT2	NT3

